

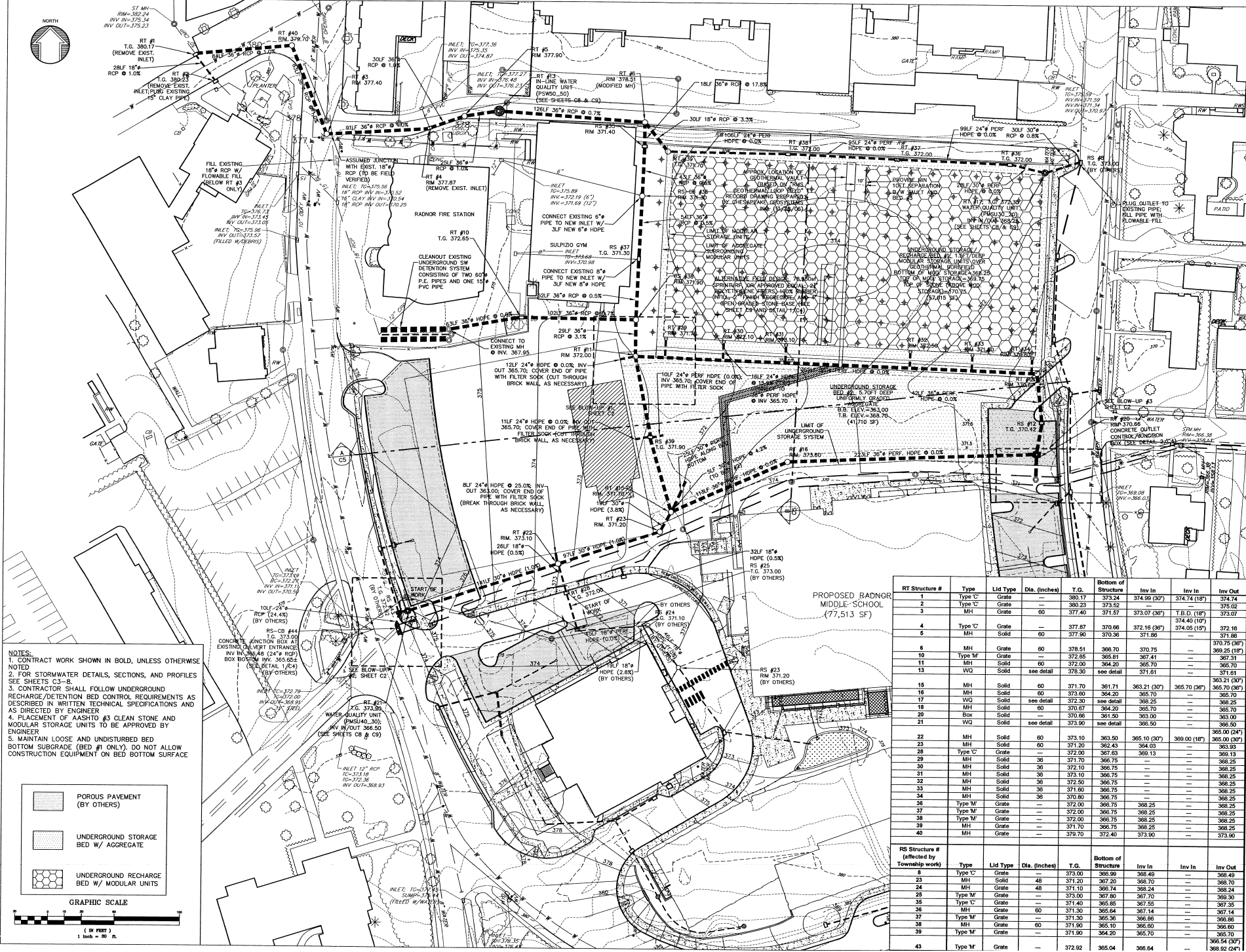

ST. MARY
 RM=362.24
 INV IN=375.34
 INV OUT=375.23

RT #1
 T.G. 380.17
 (REMOVE EXIST. INLET)

28LF 18" RCP @ 1.0%



- NOTES:
1. CONTRACT WORK SHOWN IN BOLD, UNLESS OTHERWISE NOTED
 2. FOR STORMWATER DETAILS, SECTIONS, AND PROFILES SEE SHEETS C3-B.
 3. CONTRACTOR SHALL FOLLOW UNDERGROUND RECHARGE/DETENTION BED CONTROL REQUIREMENTS AS DESCRIBED IN WRITTEN TECHNICAL SPECIFICATIONS AND AS DIRECTED BY ENGINEER
 4. PLACEMENT OF AASHTO #3 CLEAN STONE AND MODULAR STORAGE UNITS TO BE APPROVED BY ENGINEER
 5. MAINTAIN LOOSE AND UNDISTURBED BED BOTTOM SUBGRADE (BED #1 ONLY); DO NOT ALLOW CONSTRUCTION EQUIPMENT ON BED BOTTOM SURFACE

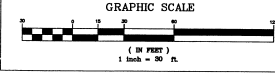
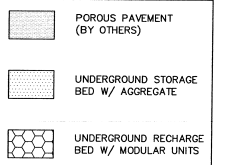

RT Structure #	Type	Lid Type	Dia. (inches)	T.G.	Bottom of Structure	Inv In	Inv In	Inv In	Inv Out
1	Type C	Grate	60	380.17	373.24	380.17	374.74 (18")	374.74	374.74
2	Type C	Grate	60	380.23	373.52	374.99 (30")	374.74 (18")	374.74	374.74
3	MH	Grate	60	377.40	371.57	373.07 (30")	T.B.D. (18")	373.07	373.07
4	Type C	Grate	60	377.87	370.66	372.16 (30")	374.40 (10")	372.16	372.16
5	MH	Solid	60	377.90	370.36	371.88	374.05 (10")	371.88	371.88
6	MH	Grate	60	378.51	368.70	370.75	370.75 (30")	370.75	370.75
10	Type M	Grate	60	372.65	365.81	367.41	---	367.41	---
11	MH	Solid	60	372.00	364.20	365.70	---	365.70	---
13	VVO	Solid	see detail	378.30	see detail	371.81	---	371.81	---
15	MH	Solid	60	371.70	361.71	363.21 (30")	365.70 (35")	363.21	363.21
16	MH	Solid	60	373.60	364.20	365.70	---	365.70	---
17	VVO	Solid	see detail	372.90	see detail	368.25	---	368.25	---
18	MH	Solid	60	370.67	364.20	365.70	---	365.70	---
20	Box	Solid	---	370.66	361.50	363.00	---	363.00	---
21	VVO	Solid	see detail	373.90	see detail	365.50	---	365.50	---
22	MH	Solid	60	373.10	363.50	365.10 (30")	369.00 (18")	365.00 (30")	365.00 (30")
23	MH	Solid	60	371.20	362.43	364.03	---	364.03	---
28	Type C	Grate	---	372.00	367.63	369.13	---	369.13	---
29	MH	Solid	36	371.70	366.75	---	---	366.75	---
30	MH	Solid	36	372.10	366.75	---	---	366.75	---
31	MH	Solid	36	373.10	366.75	---	---	366.75	---
32	MH	Solid	36	372.50	366.75	---	---	366.75	---
33	MH	Solid	36	371.60	366.75	---	---	366.75	---
34	MH	Solid	36	370.80	366.75	---	---	366.75	---
35	Type M	Grate	---	372.00	366.75	368.25	---	368.25	---
37	Type M	Grate	---	372.00	366.75	368.25	---	368.25	---
38	Type M	Grate	---	372.00	366.75	368.25	---	368.25	---
39	MH	Solid	60	371.70	366.75	368.25	---	368.25	---
40	MH	Grate	---	379.70	372.40	373.90	---	373.90	---
RS Structure #	Type	Lid Type	Dia. (inches)	T.G.	Bottom of Structure	Inv In	Inv In	Inv In	Inv Out
8	Type C	Grate	---	373.00	366.99	368.49	---	368.49	---
23	MH	Solid	48	371.20	367.20	368.70	---	368.70	---
24	MH	Grate	48	371.10	366.74	368.24	---	368.24	---
25	Type M	Grate	---	373.00	367.80	367.70	---	367.70	---
35	Type C	Grate	---	371.40	365.85	367.35	---	367.35	---
36	MH	Grate	60	371.90	365.64	367.14	---	367.14	---
37	Type M	Grate	---	371.30	365.36	366.86	---	366.86	---
38	MH	Grate	60	371.90	365.10	366.60	---	366.60	---
39	Type M	Grate	---	371.90	364.20	365.70	---	365.70	---
43	Type M	Grate	---	373.92	365.04	366.54	---	366.54 (30")	366.54 (30")

CAHILL ASSOCIATES
 Environmental Engineers,
 Scientists, & Planners
 www.cahill.com

104 S. High Street
 West Chester, PA 19382
 phone: 610.696.4150
 facsimile: 610.696.8908

Project Team
 Project
Radnor Middle School
 150 Louella Ave.
 Wayne, PA 19087

Sheet Title
TOWNSHIP STORMWATER PLAN

Warning: Actual Conditions may vary from conditions shown on this drawing. Confirm all information in the field before proceeding with any work and notify the Engineer in writing if a variation is discovered.

This drawing is an instrument of professional service and shall not be modified, copied or used for another project without the written consent of the Engineer.

Date	Comments
11/22/06	FOR REVIEW
1/23/07	FOR REVIEW
6/29/07	FOR BID

Scale: 1"=30'

Drawn By: SM
 Checked By: OPW
 Approved By: THC

Sheet No.
C1.0

