

**S18 SIDEWALK TIE-IN DETAIL**  
SCALE: N.T.S. REV: 2015.03.09

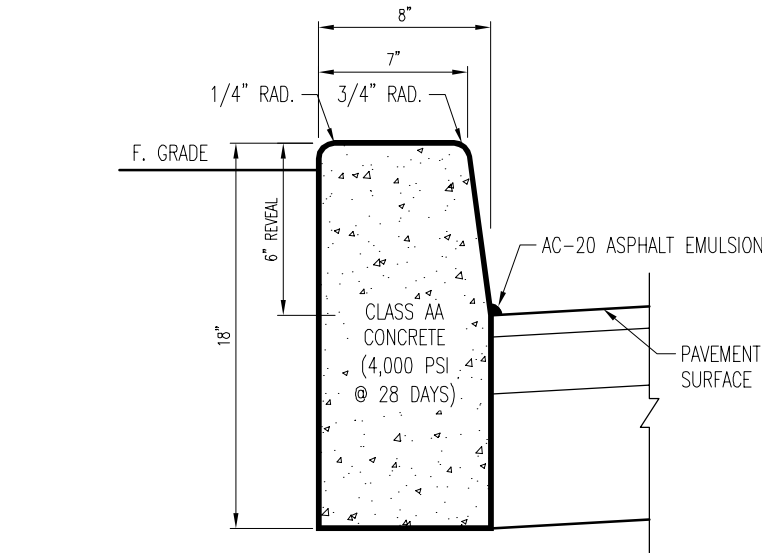

**S5 TYPICAL CONCRETE CURB DETAIL**  
SCALE: N.T.S. REV: 2017.08.02

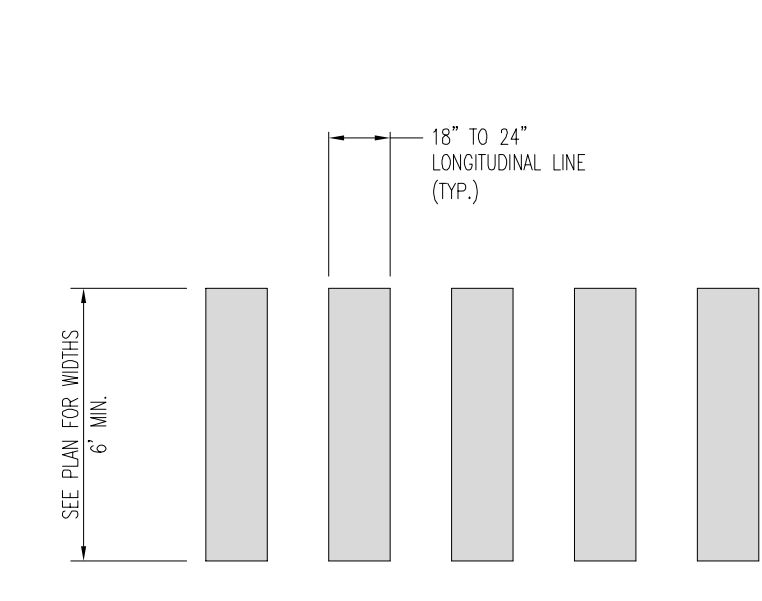

**S20 HIGH VISIBILITY CROSSWALK DETAIL (PERPENDICULAR TO INTERSECTION)**  
SCALE: N.T.S. REV: 2015.03.09

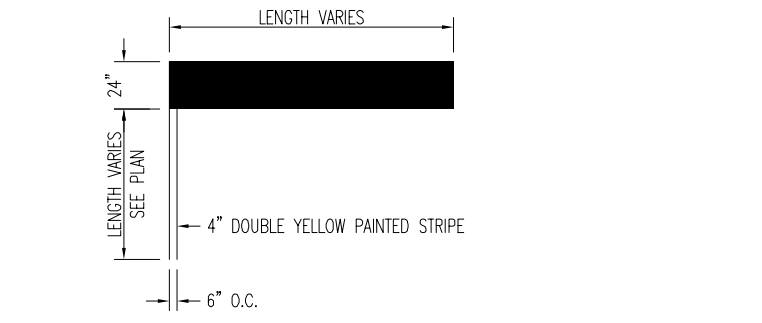

**S4 WHITE PAINTED STOP BAR DETAIL**  
SCALE: N.T.S. REV: 2016.09.29

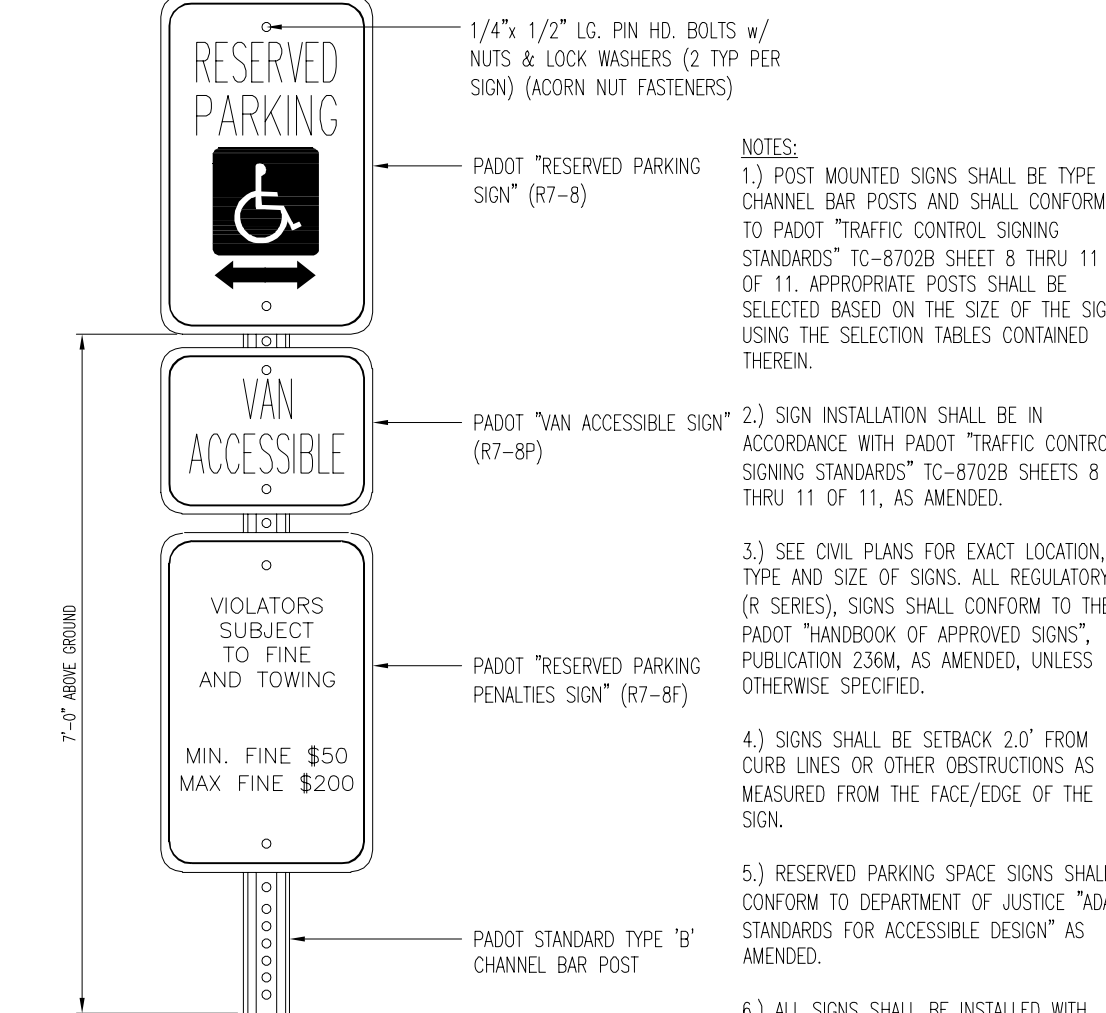

**T12 RESERVE PARKING SPACE w/ PENALTIES & VAN ACCESSIBLE SIGNS**  
SCALE: N.T.S. REV: 2016.01.05

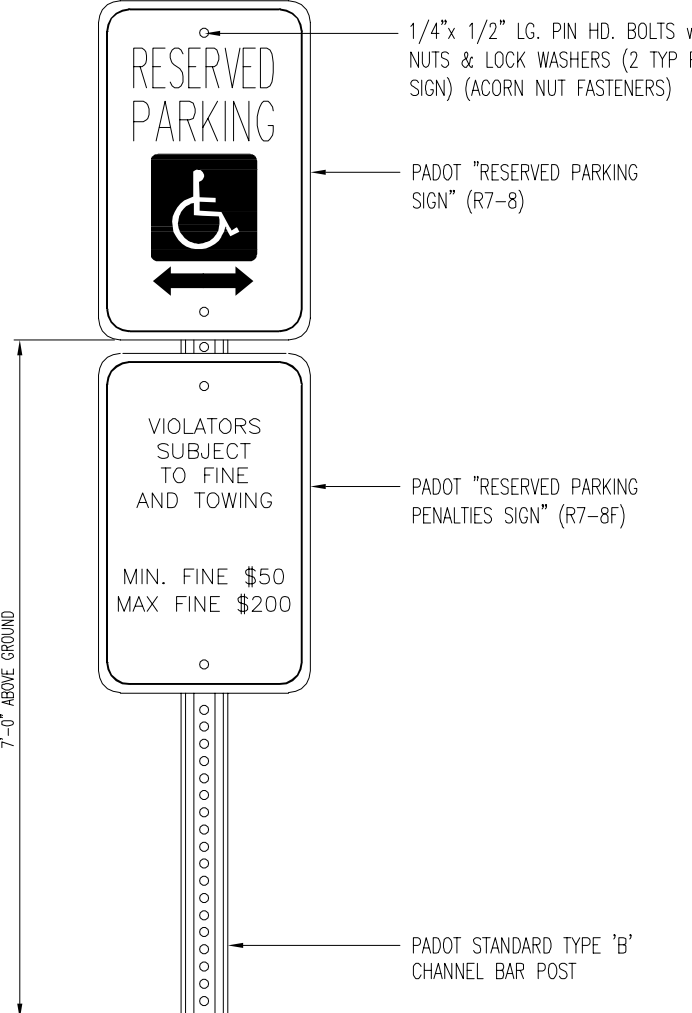

**T13 RESERVE PARKING SPACE & PENALTIES SIGNS**  
SCALE: N.T.S. REV: 2016.01.05

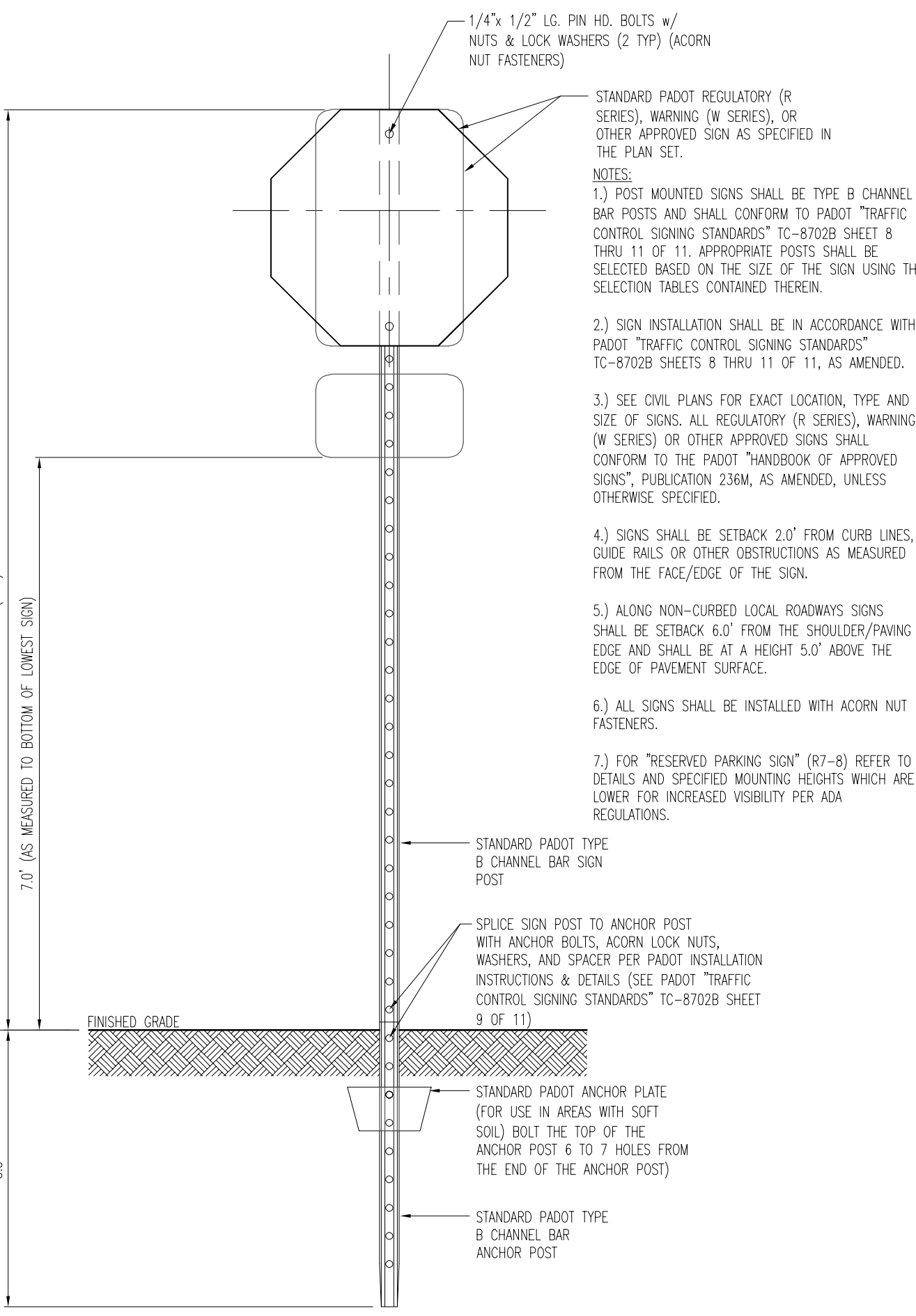

**T9 STANDARD POLE MOUNTED SIGN INSTALLATION DETAIL**  
SCALE: N.T.S. REV: 2015.03.09

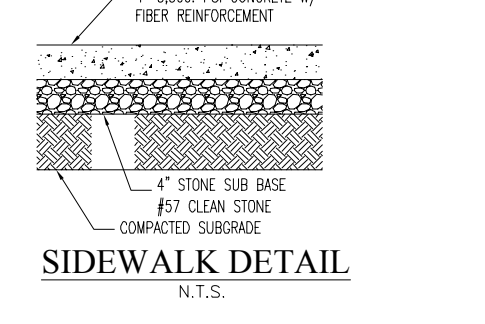

**SIDWALK DETAIL**  
N.T.S.

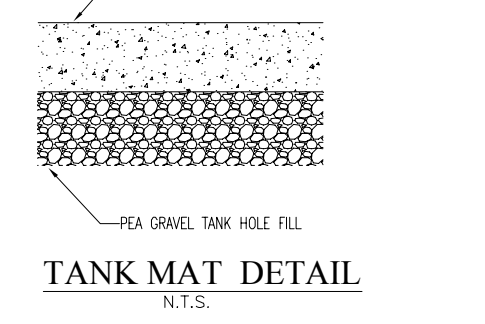

**TANK MAT DETAIL**  
N.T.S.

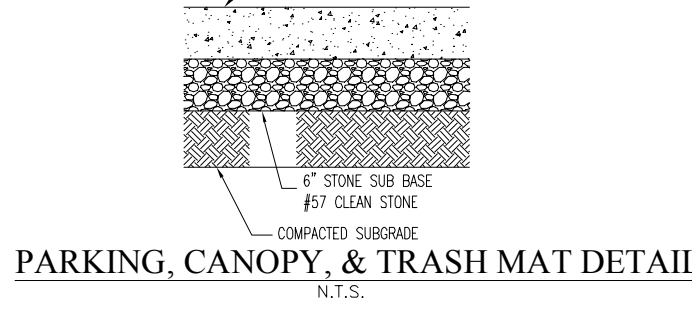

**PARKING, CANOPY, & TRASH MAT DETAIL**  
N.T.S.

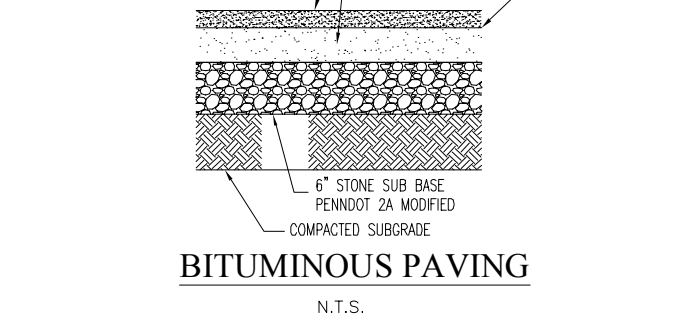

**BITUMINOUS PAVING**  
N.T.S.

**LIST OF APPLICABLE PADOT DETAILS**

REFER TO PADOT STANDARD DETAILS AS FOLLOWS:  
SIGNAGE - PA D.O.T. PUBLICATION 236 (LATEST EDITION)  
DETAILS ARE ASSOCIATED WITH THE FOLLOWING PROPOSED  
SITE IMPROVEMENTS FROM PENNDOT PUBLICATION 72M

STANDARD DRAWING NUMBER	DESCRIPTION	DRAWING DATE
RC - 39M	MANHOLES	SEPTEMBER 15, 2016
RC - 45M	INLET TOPS & GRATES	SEPTEMBER 15, 2016
RC - 46M	INLET BOXES	SEPTEMBER 15, 2016
RC - 64M	CURBS & GUTTERS	JUNE 1, 2010
RC - 67M	CURB RAMPS	JUNE 10, 2013

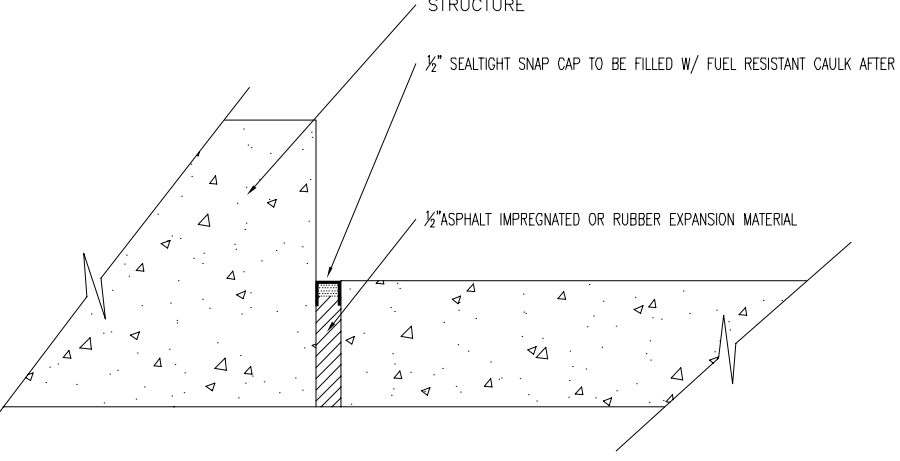

**ISOLATION JOINT DETAIL**  
N.T.S.

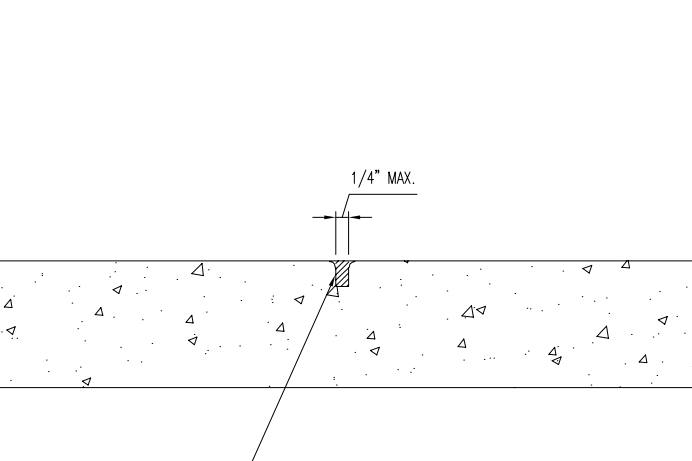

**CONTROL JOINT DETAIL**  
N.T.S.

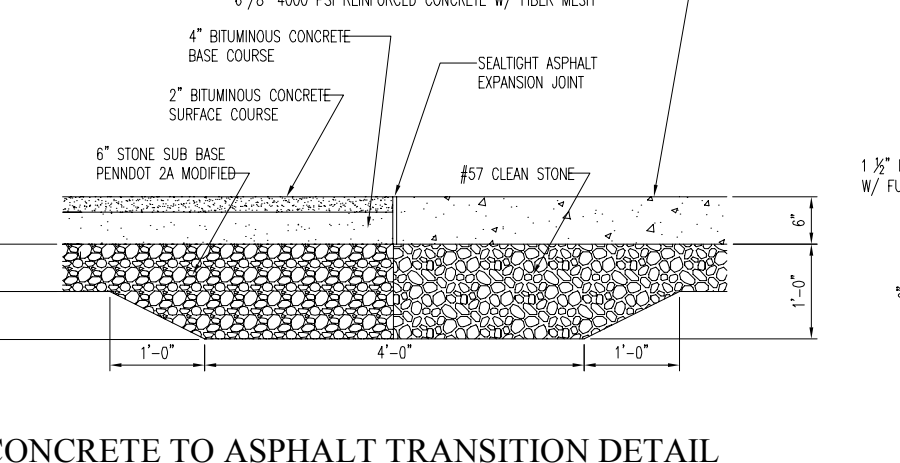

**CONCRETE TO ASPHALT TRANSITION DETAIL**  
N.T.S.

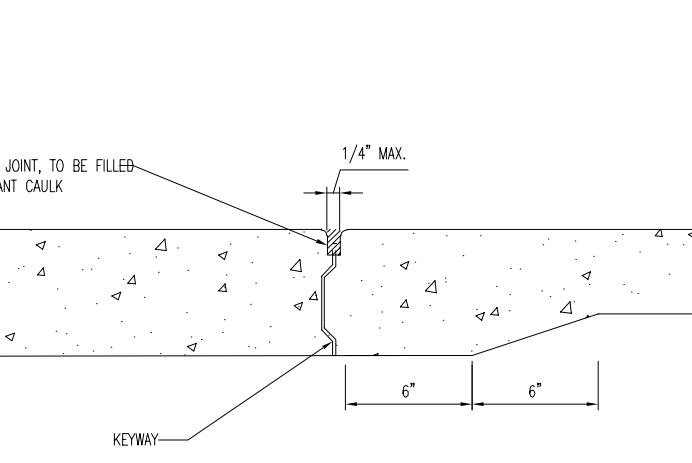

**CONSTRUCTION JOINT DETAIL**  
N.T.S.

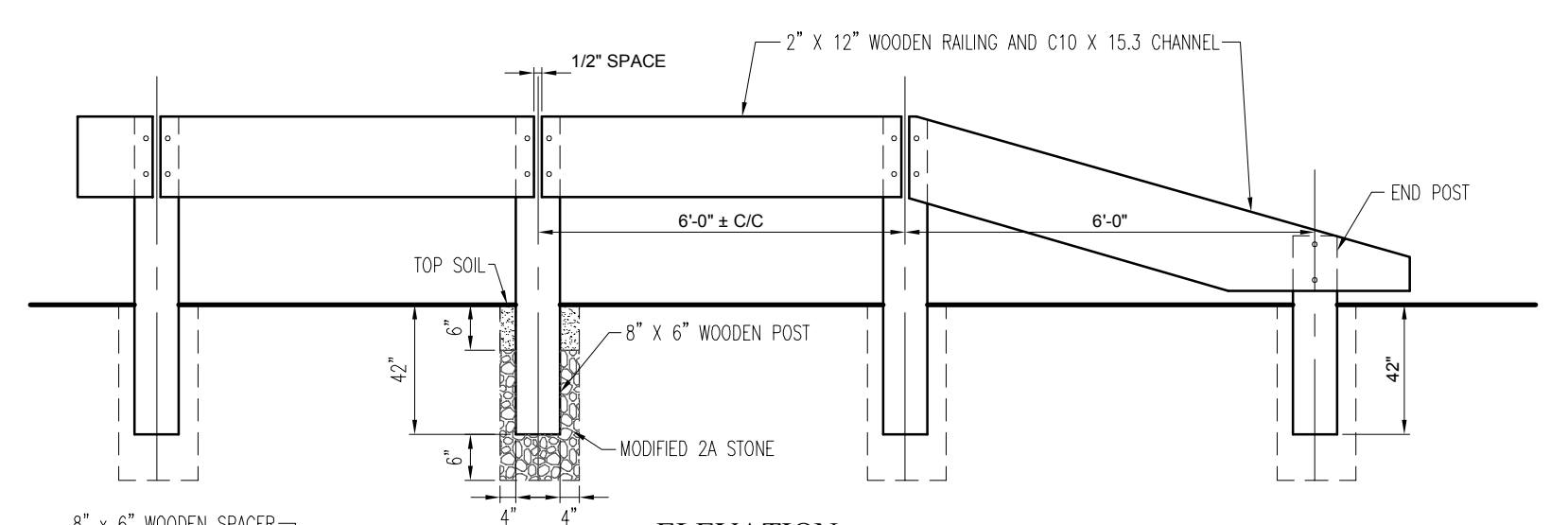

**ELEVATION**  
NOTE: ALL WOODEN MEMBERS ARE TO BE PRESSURE TREATED LUMBER  
ALL C 10 COMPONENTS ARE TO BE GALVANIZED STEEL

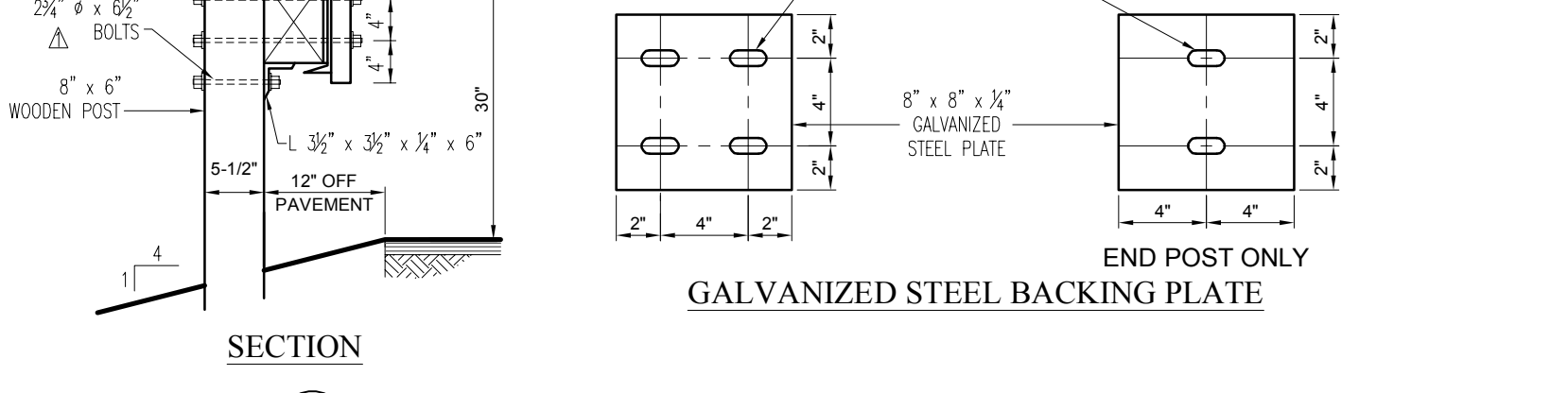

**SECTION**  
**S10 WOODEN GUIDE RAIL DETAIL**  
SCALE: N.T.S. REV: 2017.01.25

**BOHLER ENGINEERING**  
SITE CIVIL AND CONSULTING ENGINEERING  
LAND SURVEYING PROGRAM MANAGEMENT LANDSCAPE ARCHITECTURE  
SUSTAINABLE DESIGN PERMITTING SERVICES TRANSPORTATION SERVICES  
PAINTING & SIGNAGE  
• ALABAMA • ARIZONA • ARKANSAS • CALIFORNIA • COLORADO • CONNECTICUT • DELAWARE • FLORIDA • GEORGIA • ILLINOIS • INDIANA • IOWA • KANSAS • KENTUCKY • LOUISIANA • MARYLAND • MASSACHUSETTS • MICHIGAN • MINNESOTA • MISSISSIPPI • MISSOURI • MONTANA • NEBRASKA • NEVADA • NEW HAMPSHIRE • NEW JERSEY • NEW YORK • NORTH CAROLINA • NORTH DAKOTA • OHIO • OKLAHOMA • PENNSYLVANIA • RHODE ISLAND • SOUTH CAROLINA • SOUTH DAKOTA • TEXAS • VIRGINIA • WASHINGTON • WISCONSIN • WYOMING

**REVISIONS**

REV	DATE	COMMENT	BY
1	08/31/2018	PER DOT COMMENTS	MCM

**CALL BEFORE YOU DIG!**  
PENNSYLVANIA LAW REQUIRES  
3 WORKING DAYS NOTICE FOR  
CONSTRUCTION PHASE AND 10  
WORKING DAYS IN DESIGN  
STAGE - STOP CALL  
**PAI**  
1-800-242-1776

**NOT APPROVED FOR CONSTRUCTION**  
PROJECT No.: PC181016  
DRAWN BY: MCM  
CHECKED BY: EAB  
DATE: 2018.07.13  
SCALE: AS NOTED  
CAD I.D.: PC181016 DETAILS-1

**PRELIMINARY LAND DEVELOPMENT PLANS**  
FOR  
**WAYNE PROPERTY ACQUISITION INC.**  
ROUTE 30 (LANCASTER AVE)  
& ABERDEEN AVE  
RADNOR TOWNSHIP  
DELAWARE COUNTY, PA

**BOHLER ENGINEERING**  
1600 MANOR DRIVE, SUITE 200  
CHALFONT, PENNSYLVANIA 18914  
Phone: (215) 996-9100  
Fax: (215) 996-9102  
www.BohlerEngineering.com

**EA BRITZ**  
PROFESSIONAL ENGINEER  
PENNSYLVANIA LICENSE # PE071643

SHEET TITLE:  
**DETAILS**  
SHEET NUMBER:  
**16**  
OF 19  
REVISION 1 - 2018.08.31

R:\1\PC181016\DRAWINGS\PLAN SETS\LAND DEV\REV\PC181016 DETAILS-1 - LAYOUT-16-DETAILS