

DISTRICT	COUNTY	ROUTE	SECTION	SHEET
6-0	DELAWARE	0030	RRT	1 OF 13
RADNOR TOWNSHIP				
REVISION NUMBER	REVISIONS			DATE BY

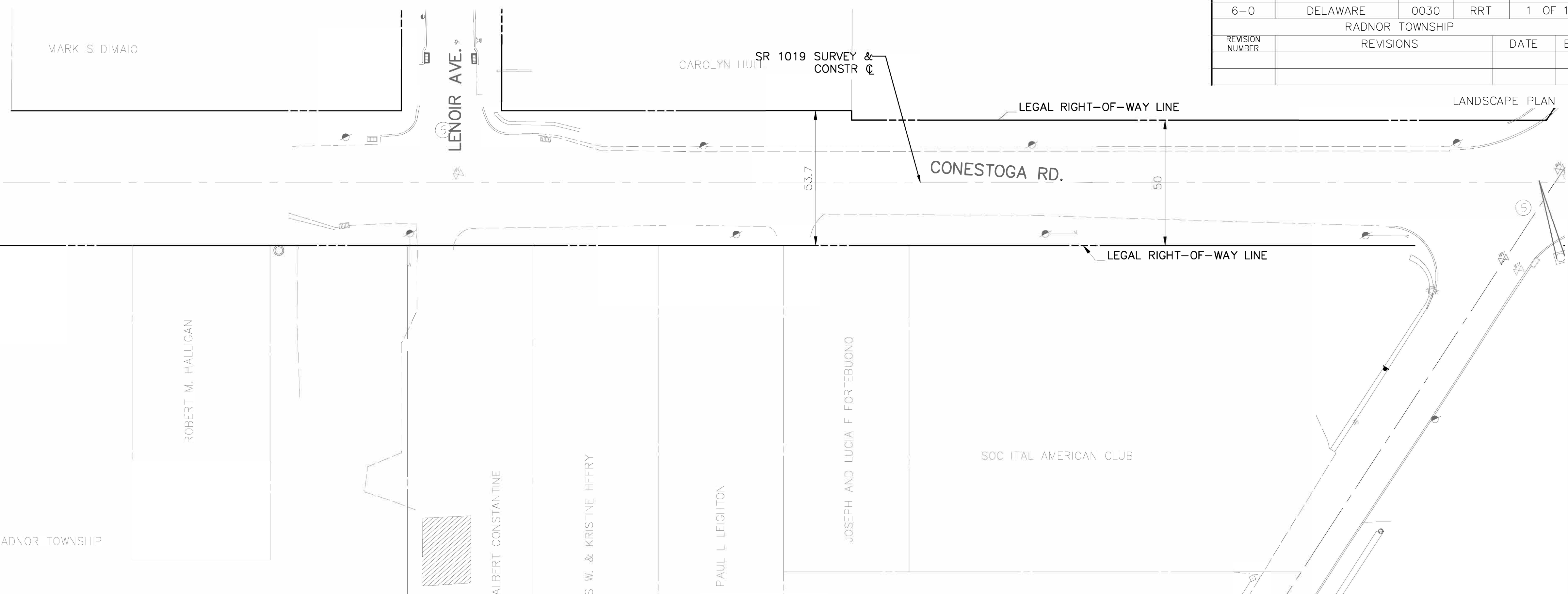
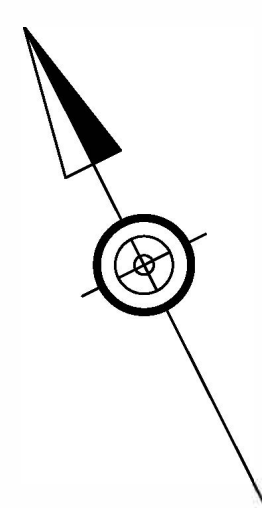

PLANT SCHEDULE:

ITEM NUMBER	ITEM NUMBER	QTY	
4808-3274	AMERICAN SYCAMORE - (2 1/2" CAL. B&B) MODIFIED	3	EA
4808-3323	SWAMP WHITE OAK - (2 1/2" CAL. B&B) MODIFIED	3	EA
4808-3353	WILLOW OAK - (2 1/2" CAL. B&B) MODIFIED	3	EA

NOTES:
1. SEE THE EROSION AND SEDIMENTATION POLLUTION CONTROL PLAN SET FOR SEEDING TYPES.

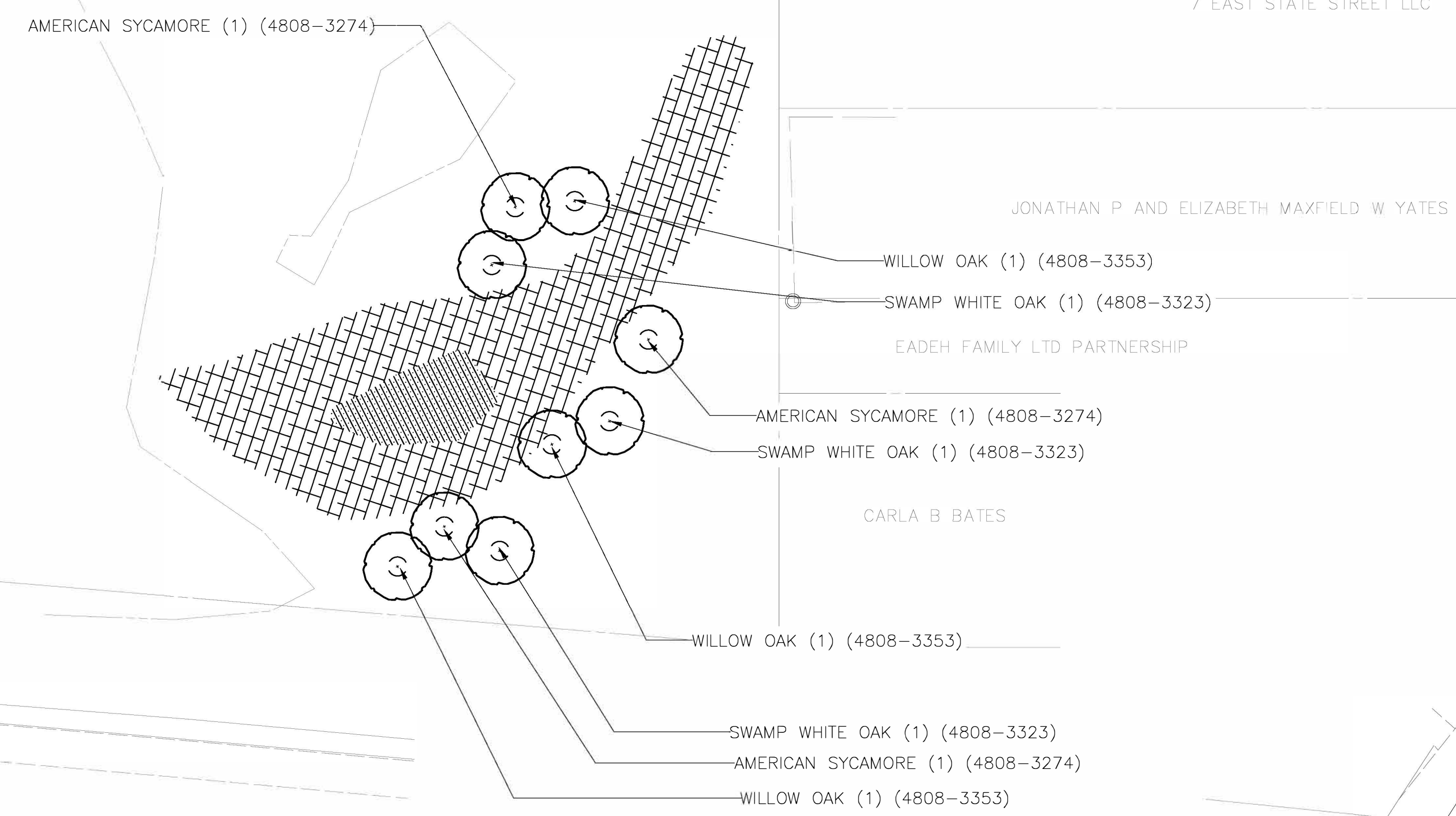

LEGEND

- PROPOSED SHADE TREE
- BASINS
- SLOPES 4:1 OR GREATER
- FINAL CONDITION LAWNS

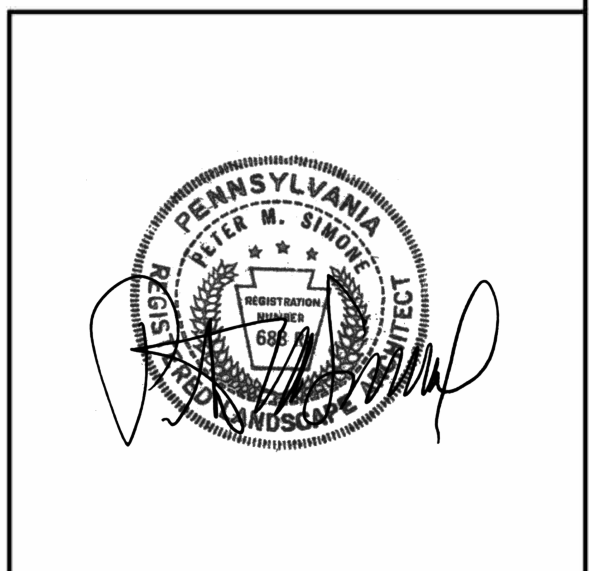
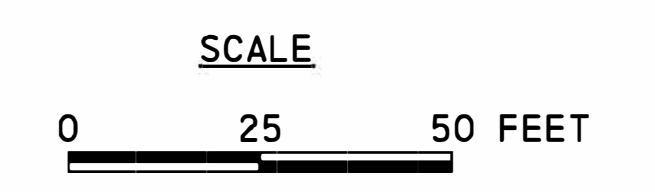

DISTRICT	COUNTY	ROUTE	SECTION	SHEET
6-0	DELAWARE	0030	RRT	2 OF 13
RADNOR TOWNSHIP				
REVISION NUMBER	REVISIONS	DATE	BY	

LANDSCAPE PLAN

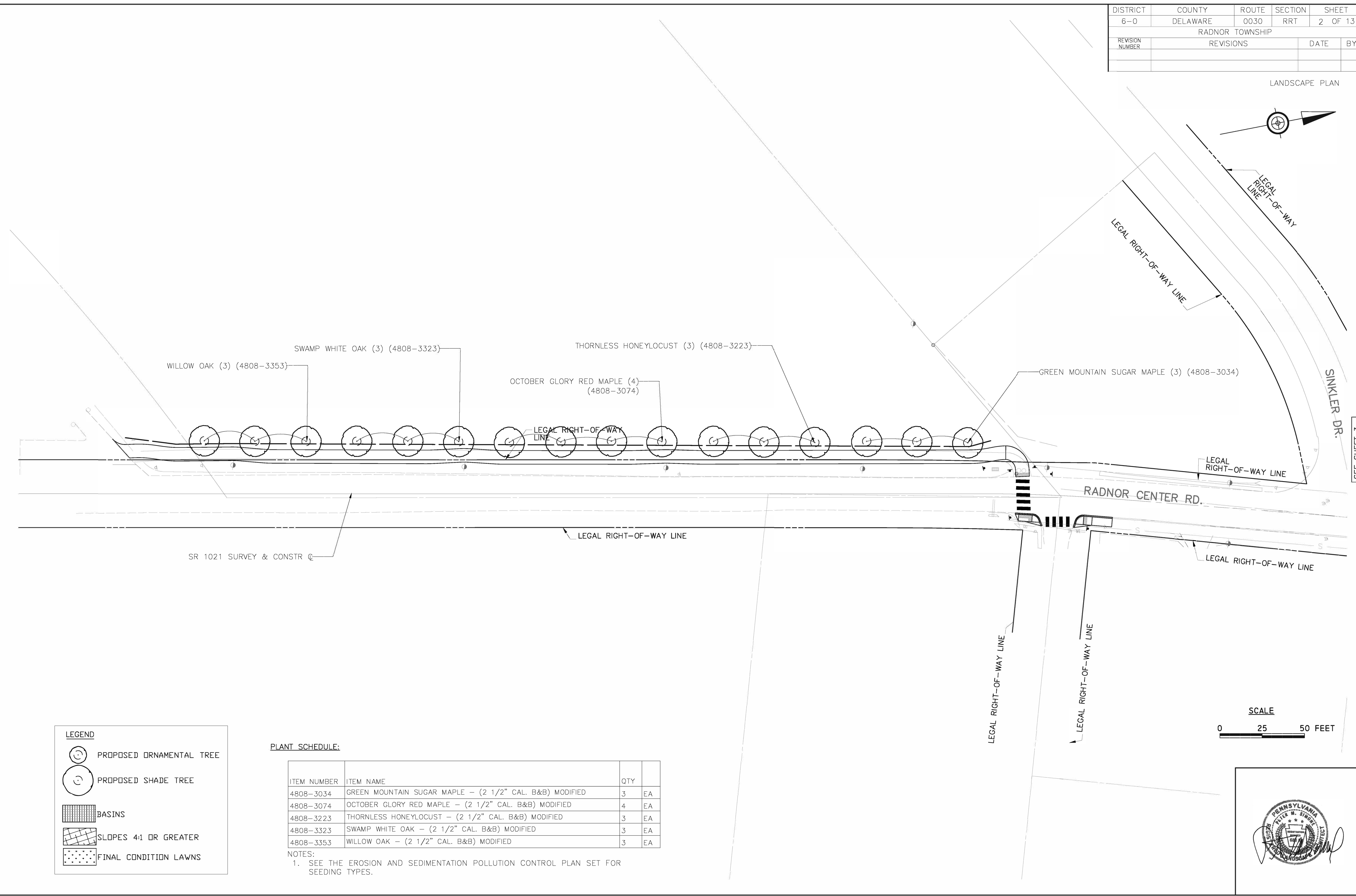
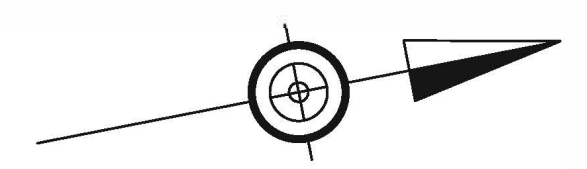

WILLOW OAK (3) (4808-3353) SWAMP WHITE OAK (3) (4808-3323) THORNLESS HONEYLOCUST (3) (4808-3223) OCTOBER GLORY RED MAPLE (4) (4808-3074) GREEN MOUNTAIN SUGAR MAPLE (3) (4808-3034)

LEGEND

	PROPOSED ORNAMENTAL TREE
	PROPOSED SHADE TREE
	BASINS
	SLOPES 4:1 OR GREATER
	FINAL CONDITION LAWNS

PLANT SCHEDULE:

ITEM NUMBER	ITEM NAME	QTY	
4808-3034	GREEN MOUNTAIN SUGAR MAPLE - (2 1/2" CAL. B&B) MODIFIED	3	EA
4808-3074	OCTOBER GLORY RED MAPLE - (2 1/2" CAL. B&B) MODIFIED	4	EA
4808-3223	THORNLESS HONEYLOCUST - (2 1/2" CAL. B&B) MODIFIED	3	EA
4808-3323	SWAMP WHITE OAK - (2 1/2" CAL. B&B) MODIFIED	3	EA
4808-3353	WILLOW OAK - (2 1/2" CAL. B&B) MODIFIED	3	EA

NOTES:
 1. SEE THE EROSION AND SEDIMENTATION POLLUTION CONTROL PLAN SET FOR SEEDING TYPES.

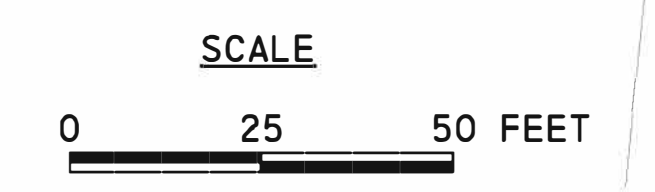

SEE SHEET 3

DISTRICT	COUNTY	ROUTE	SECTION	SHEET
6-0	DELAWARE	0030	RRT	3 OF 13
RADNOR TOWNSHIP				
REVISION NUMBER	REVISIONS			DATE BY

LANDSCAPE PLAN

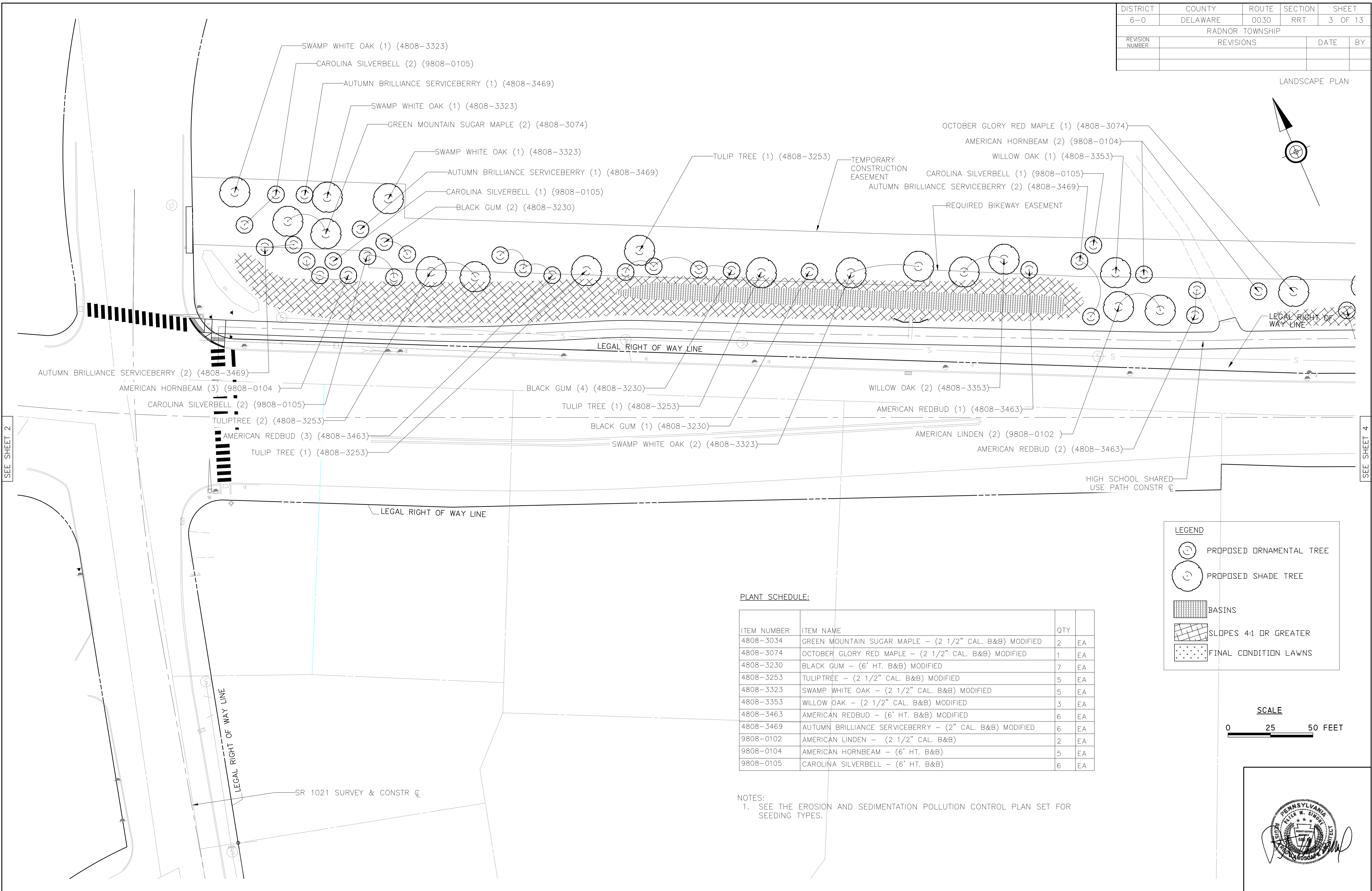
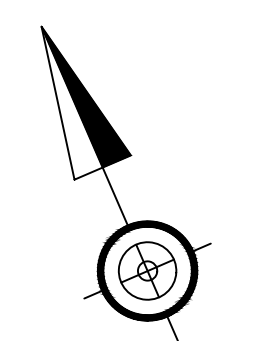

SEE SHEET 2

SEE SHEET 4

PLANT SCHEDULE:

ITEM NUMBER	ITEM NAME	QTY	
4808-3034	GREEN MOUNTAIN SUGAR MAPLE - (2 1/2" CAL. B&B) MODIFIED	2	EA
4808-3074	OCTOBER GLORY RED MAPLE - (2 1/2" CAL. B&B) MODIFIED	1	EA
4808-3230	BLACK GUM - (6' HT. B&B) MODIFIED	7	EA
4808-3253	TULIPTREE - (2 1/2" CAL. B&B) MODIFIED	5	EA
4808-3323	SWAMP WHITE OAK - (2 1/2" CAL. B&B) MODIFIED	5	EA
4808-3353	WILLOW OAK - (2 1/2" CAL. B&B) MODIFIED	3	EA
4808-3463	AMERICAN REDBUD - (6' HT. B&B) MODIFIED	6	EA
4808-3469	AUTUMN BRILLIANCE SERVICEBERRY - (2" CAL. B&B) MODIFIED	6	EA
9808-0102	AMERICAN LINDEN - (2 1/2" CAL. B&B)	2	EA
9808-0104	AMERICAN HORNBEAM - (6' HT. B&B)	5	EA
9808-0105	CAROLINA SILVERBELL - (6' HT. B&B)	6	EA

LEGEND

	PROPOSED ORNAMENTAL TREE
	PROPOSED SHADE TREE
	BASINS
	SLOPES 4:1 OR GREATER
	FINAL CONDITION LAWNS

SCALE
0 25 50 FEET

NOTES:
1. SEE THE EROSION AND SEDIMENTATION POLLUTION CONTROL PLAN SET FOR SEEDING TYPES.



DISTRICT	COUNTY	ROUTE	SECTION	SHEET
6-0	DELAWARE	0030	RRT	4 OF 13
RADNOR TOWNSHIP				
REVISION NUMBER	REVISIONS			DATE BY

LANDSCAPE PLAN

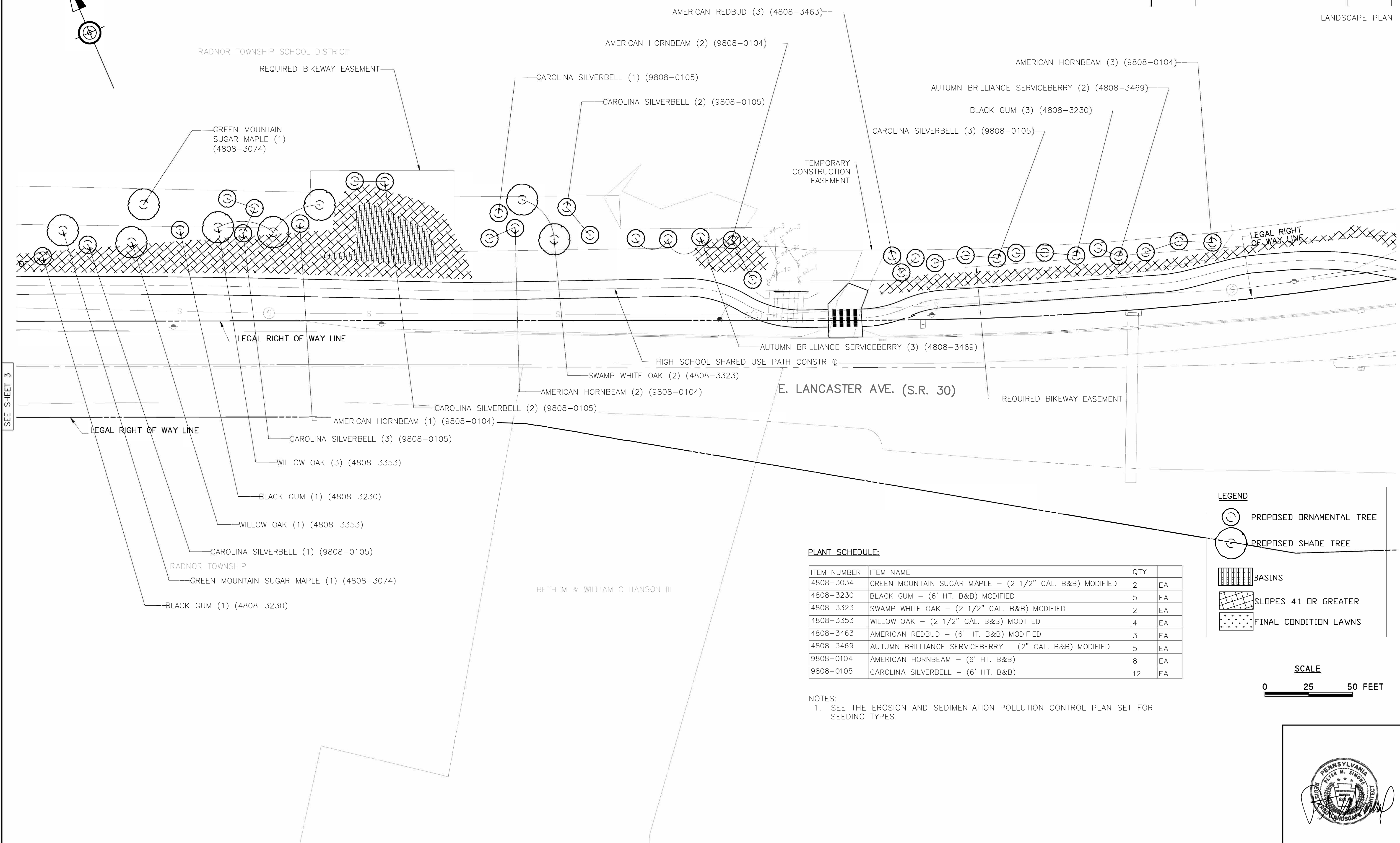
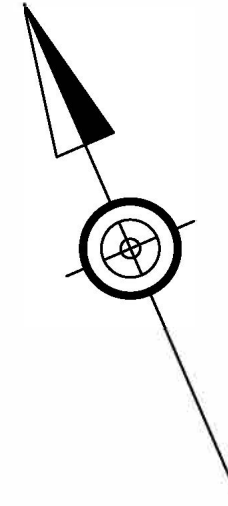

SEE SHEET 3

SEE SHEET 5

PLANT SCHEDULE:

ITEM NUMBER	ITEM NAME	QTY	
4808-3034	GREEN MOUNTAIN SUGAR MAPLE - (2 1/2" CAL. B&B) MODIFIED	2	EA
4808-3230	BLACK GUM - (6' HT. B&B) MODIFIED	5	EA
4808-3323	SWAMP WHITE OAK - (2 1/2" CAL. B&B) MODIFIED	2	EA
4808-3353	WILLOW OAK - (2 1/2" CAL. B&B) MODIFIED	4	EA
4808-3463	AMERICAN REDBUD - (6' HT. B&B) MODIFIED	3	EA
4808-3469	AUTUMN BRILLIANCE SERVICEBERRY - (2" CAL. B&B) MODIFIED	5	EA
9808-0104	AMERICAN HORNBEAM - (6' HT. B&B)	8	EA
9808-0105	CAROLINA SILVERBELL - (6' HT. B&B)	12	EA

LEGEND

	PROPOSED ORNAMENTAL TREE
	PROPOSED SHADE TREE
	BASINS
	SLOPES 4:1 OR GREATER
	FINAL CONDITION LAWNS

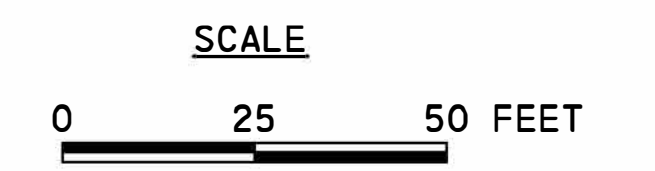

NOTES:
 1. SEE THE EROSION AND SEDIMENTATION POLLUTION CONTROL PLAN SET FOR SEEDING TYPES.



DISTRICT	COUNTY	ROUTE	SECTION	SHEET
6-0	DELAWARE	0030	RRT	5 OF 13
RADNOR TOWNSHIP				
REVISION NUMBER	REVISIONS	DATE	BY	

LANDSCAPE PLAN

RADNOR TOWNSHIP SCHOOL DISTRICT

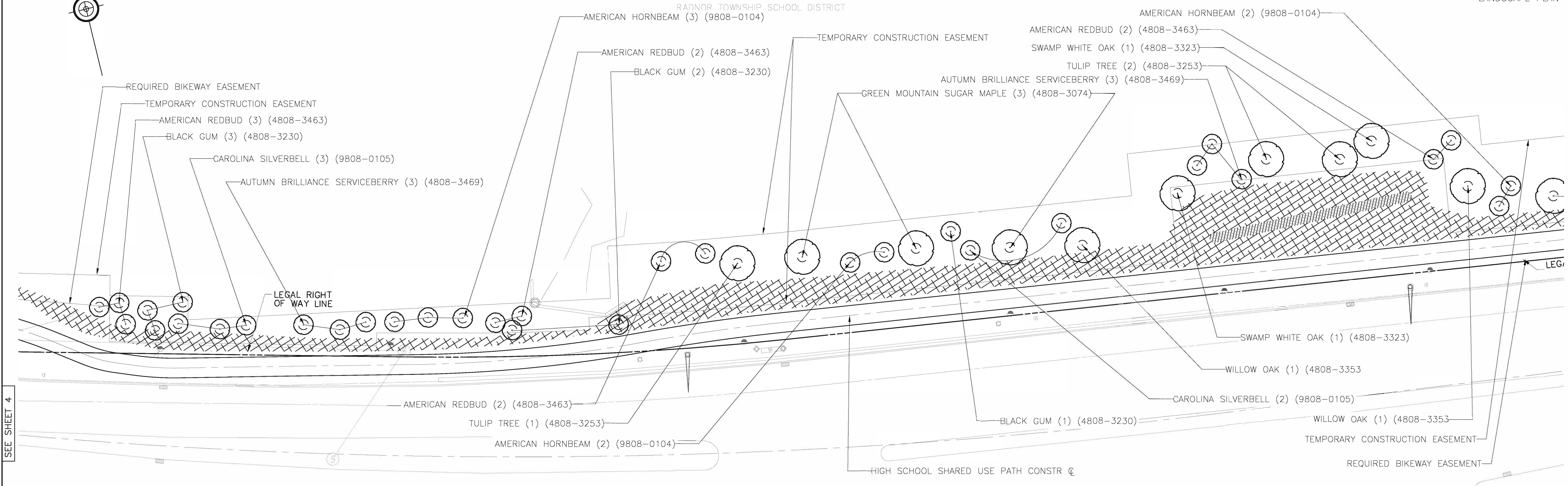
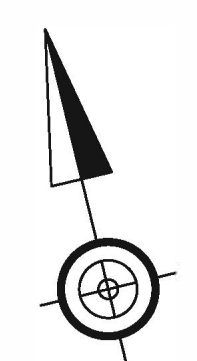

SEE SHEET 4

SEE SHEET 6

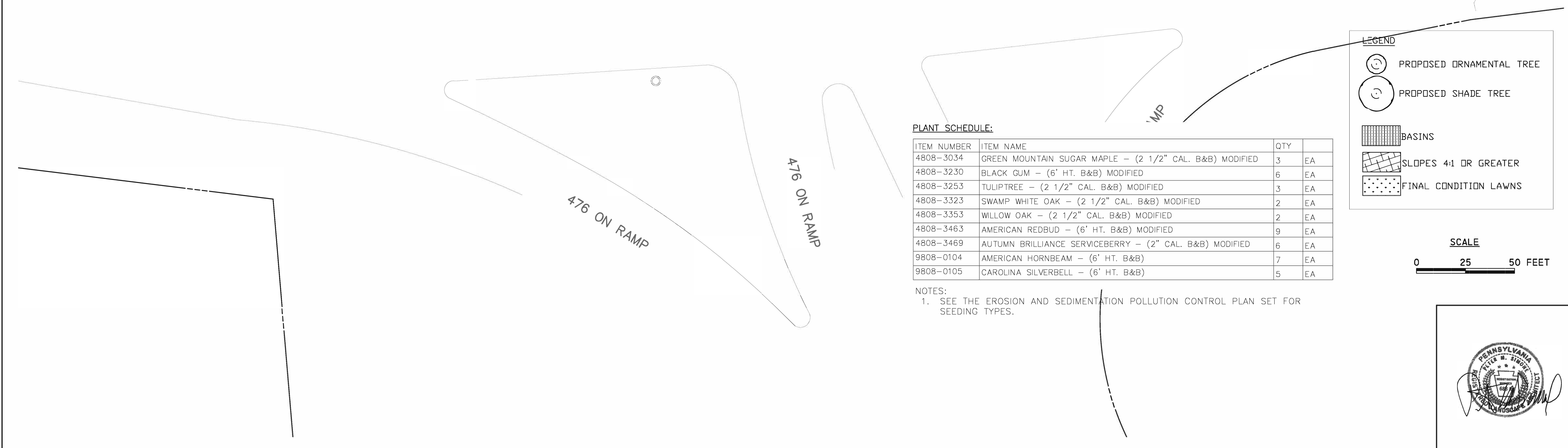

PLANT SCHEDULE:

ITEM NUMBER	ITEM NAME	QTY	EA
4808-3034	GREEN MOUNTAIN SUGAR MAPLE - (2 1/2" CAL. B&B) MODIFIED	3	EA
4808-3230	BLACK GUM - (6' HT. B&B) MODIFIED	6	EA
4808-3253	TULIPTREE - (2 1/2" CAL. B&B) MODIFIED	3	EA
4808-3323	SWAMP WHITE OAK - (2 1/2" CAL. B&B) MODIFIED	2	EA
4808-3353	WILLOW OAK - (2 1/2" CAL. B&B) MODIFIED	2	EA
4808-3463	AMERICAN REDBUD - (6' HT. B&B) MODIFIED	9	EA
4808-3469	AUTUMN BRILLIANCE SERVICEBERRY - (2" CAL. B&B) MODIFIED	6	EA
9808-0104	AMERICAN HORNBEAM - (6' HT. B&B)	7	EA
9808-0105	CAROLINA SILVERBELL - (6' HT. B&B)	5	EA

LEGEND

- PROPOSED ORNAMENTAL TREE
- PROPOSED SHADE TREE
- BASINS
- SLOPES 4:1 OR GREATER
- FINAL CONDITION LAWNS

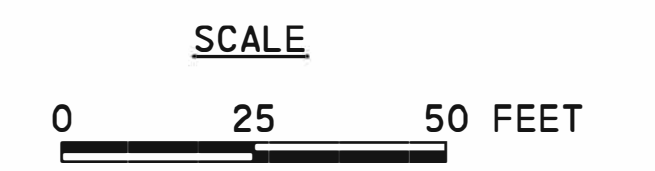

NOTES:
 1. SEE THE EROSION AND SEDIMENTATION POLLUTION CONTROL PLAN SET FOR SEEDING TYPES.



DISTRICT	COUNTY	ROUTE	SECTION	SHEET
6-0	DELAWARE	0030	RRT	6 OF 13
RADNOR TOWNSHIP				
REVISION NUMBER	REVISIONS		DATE	BY

LANDSCAPE PLAN

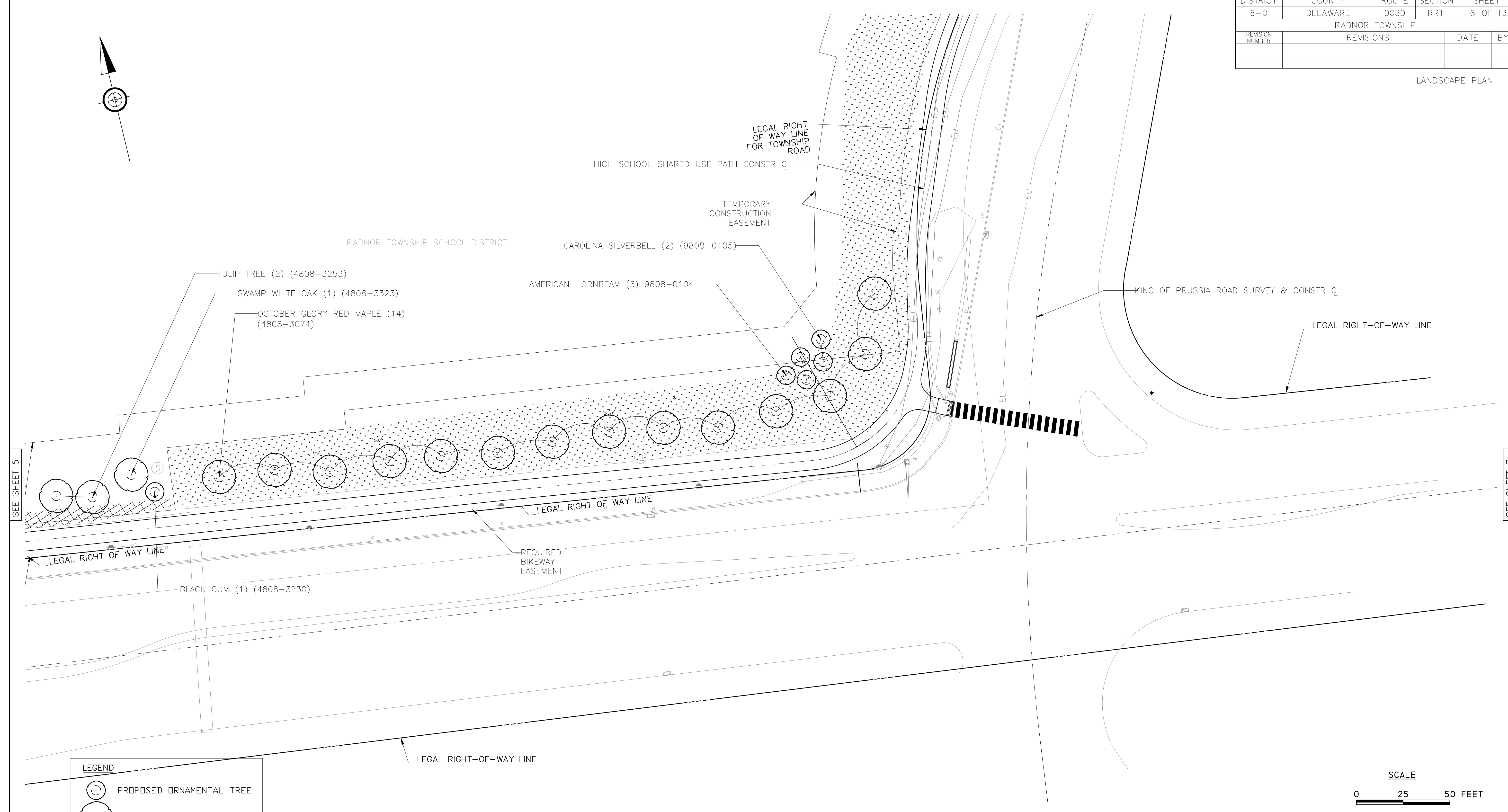
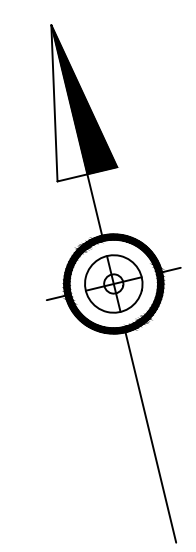

SEE SHEET 5

SEE SHEET 7

LEGEND

	PROPOSED ORNAMENTAL TREE
	PROPOSED SHADE TREE
	BASINS
	SLOPES 4:1 OR GREATER
	FINAL CONDITION LAWNS

PLANT SCHEDULE:

ITEM NUMBER	ITEM NAME	QTY	
4808-3074	OCTOBER GLORY RED MAPLE - (2 1/2" CAL. B&B) MODIFIED	14	EA
4808-3230	BLACK GUM - (6' HT. B&B) MODIFIED	1	EA
4808-3253	TULIPTREE - (2 1/2" CAL. B&B) MODIFIED	2	EA
4808-3323	SWAMP WHITE OAK - (2 1/2" CAL. B&B) MODIFIED	1	EA
9808-0104	AMERICAN HORNBEAM - (6' HT. B&B)	3	EA
9808-0105	CAROLINA SILVERBELL - (6' HT. B&B)	2	EA

NOTES:

- SEE THE EROSION AND SEDIMENTATION POLLUTION CONTROL PLAN SET FOR SEEDING TYPES.

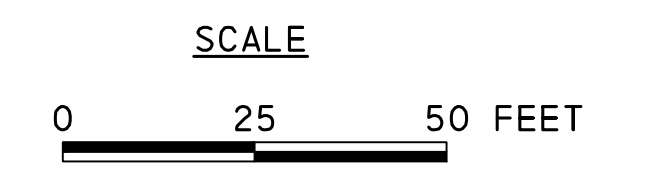

DISTRICT	COUNTY	ROUTE	SECTION	SHEET
6-0	DELAWARE	0030	RRT	7 OF 13
RADNOR TOWNSHIP				
REVISION NUMBER	REVISIONS			DATE BY

LANDSCAPE PLAN

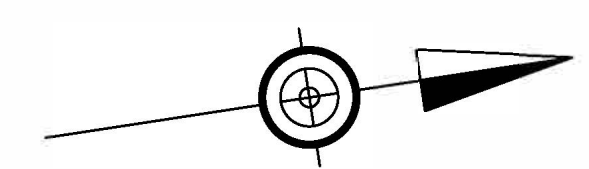

LEGEND

- PROPOSED ORNAMENTAL TREE
- PROPOSED SHADE TREE
- BASINS
- SLOPES 4:1 OR GREATER
- FINAL CONDITION LAWNS

PLANT SCHEDULE:

ITEM NUMBER	ITEM NAME	QTY	
4808-3037	GREEN MOUNTAIN SUGAR MAPLE - (4" CAL. B&B) MODIFIED	5	EA
4808-3226	THORNLESS HONEYLOCUST - (4" CAL. B&B) MODIFIED	4	EA
4808-3230	BLACK GUM - (6' HT. B&B) MODIFIED	4	EA
4808-3463	AMERICAN REDBUD - (6' HT. B&B) MODIFIED	4	EA
4808-3469	AUTUMN BRILLIANCE SERVICEBERRY - (2" CAL. B&B) MODIFIED	2	EA
9808-0101	TULIP TREE - (4" CAL. B&B)	2	EA
9808-0103	AMERICAN LINDEN - (4" CAL. B&B)	6	EA
9808-0104	AMERICAN HORNBEAM - (6' HT. B&B)	1	EA
9808-0105	CAROLINA SILVERBELL - (6' HT. B&B)	1	EA

NOTES:
1. SEE THE EROSION AND SEDIMENTATION POLLUTION CONTROL PLAN SET FOR SEEDING TYPES.

NOTES:
1. SEE THE EROSION AND SEDIMENTATION POLLUTION CONTROL PLAN SET FOR SEEDING TYPES.

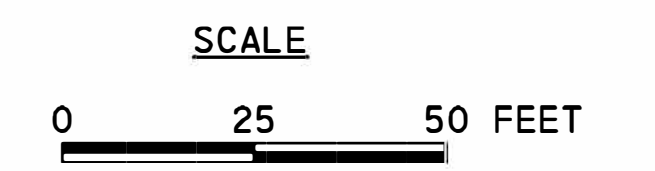
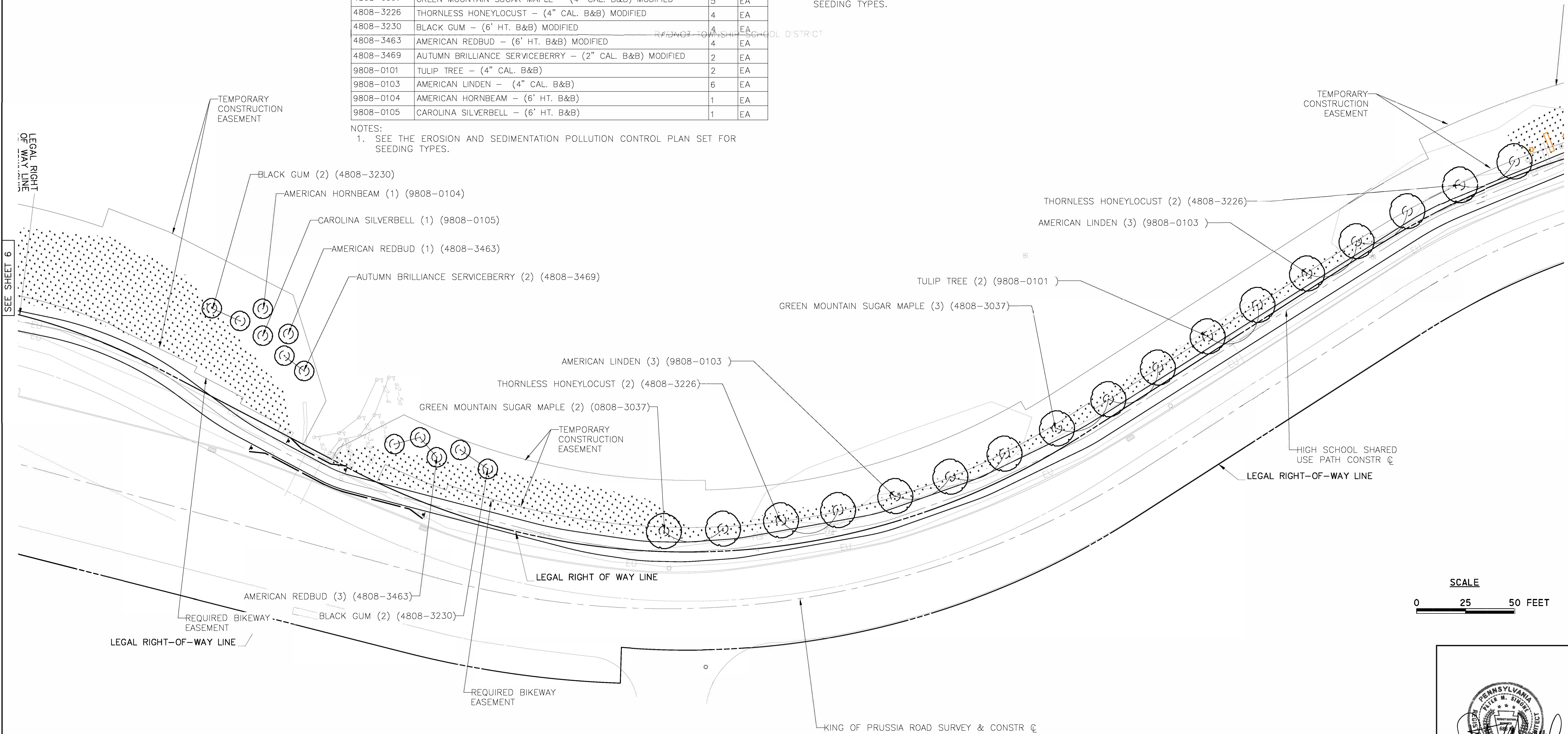

KING OF PRUSSIA ROAD SURVEY & CONSTR ©

DISTRICT	COUNTY	ROUTE	SECTION	SHEET
6-0	DELAWARE	0030	RRT	8 OF 13
RADNOR TOWNSHIP				
REVISION NUMBER	REVISIONS		DATE	BY

LANDSCAPE PLAN

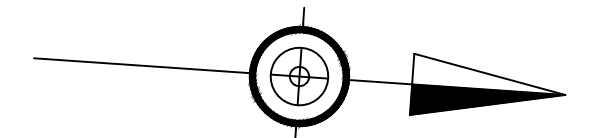

SEE SHEET 11 OF 12

RADNOR TOWNSHIP SCHOOL DISTRICT

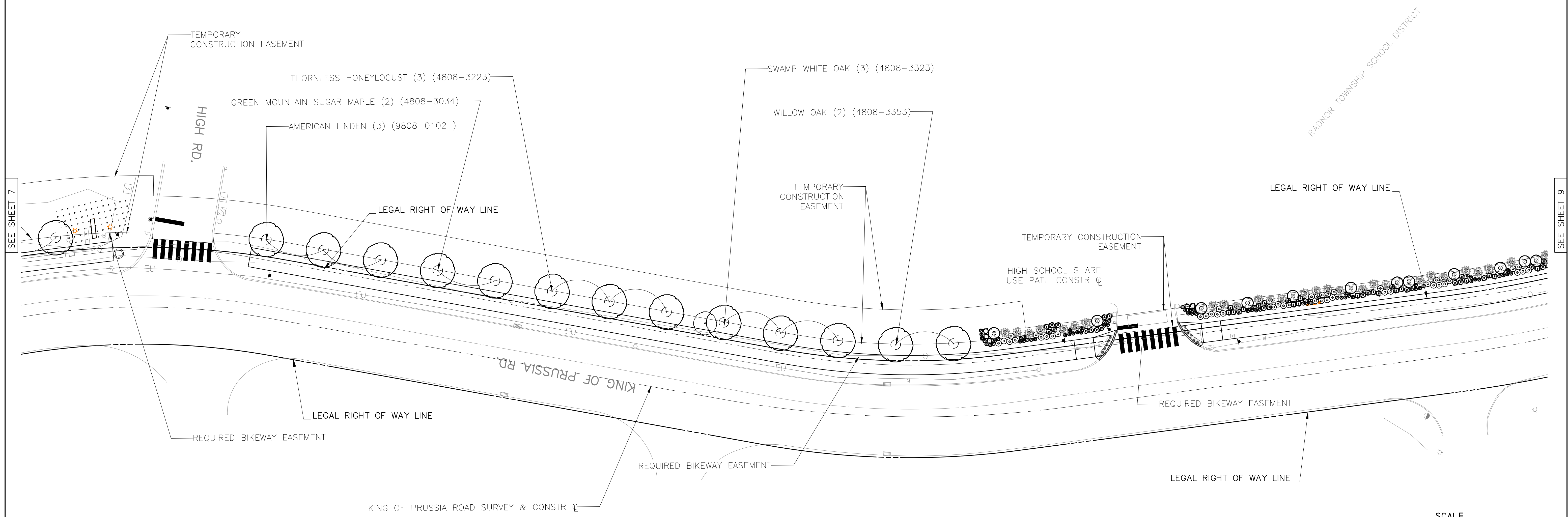

SEE SHEET 7

SEE SHEET 9

PLANT SCHEDULE:

ITEM NUMBER	ITEM NAME	QTY	
4808-3034	GREEN MOUNTAIN SUGAR MAPLE - (2 1/2" CAL. B&B) MODIFIED	2	EA
4808-3223	THORNLESS HONEYLOCUST - (2 1/2" CAL. B&B) MODIFIED	3	EA
4808-3323	SWAMP WHITE OAK - (2 1/2" CAL. B&B) MODIFIED	3	EA
4808-3353	WILLOW OAK - (2 1/2" CAL. B&B) MODIFIED	2	EA
9808-0102	AMERICAN LINDEN - (2 1/2" CAL. B&B)	3	EA

LEGEND	
	PROPOSED ORNAMENTAL TREE
	PROPOSED SHADE TREE
	BASINS
	SLOPES 4:1 OR GREATER
	FINAL CONDITION LAWNS

NOTES:
1. SEE THE EROSION AND SEDIMENTATION POLLUTION CONTROL PLAN SET FOR SEEDING TYPES.

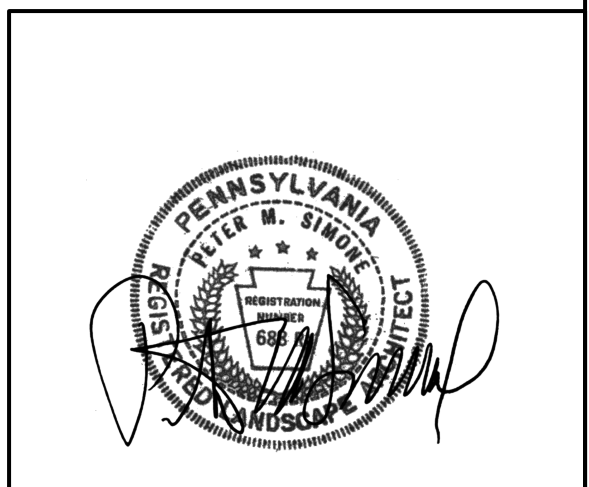
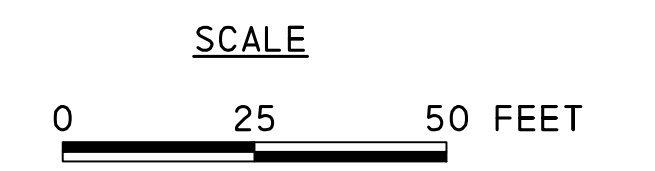

DISTRICT	COUNTY	ROUTE	SECTION	SHEET
6-0	DELAWARE	0030	RRT	9 OF 13
RADNOR TOWNSHIP				
REVISION NUMBER	REVISIONS		DATE	BY

LANDSCAPE PLAN

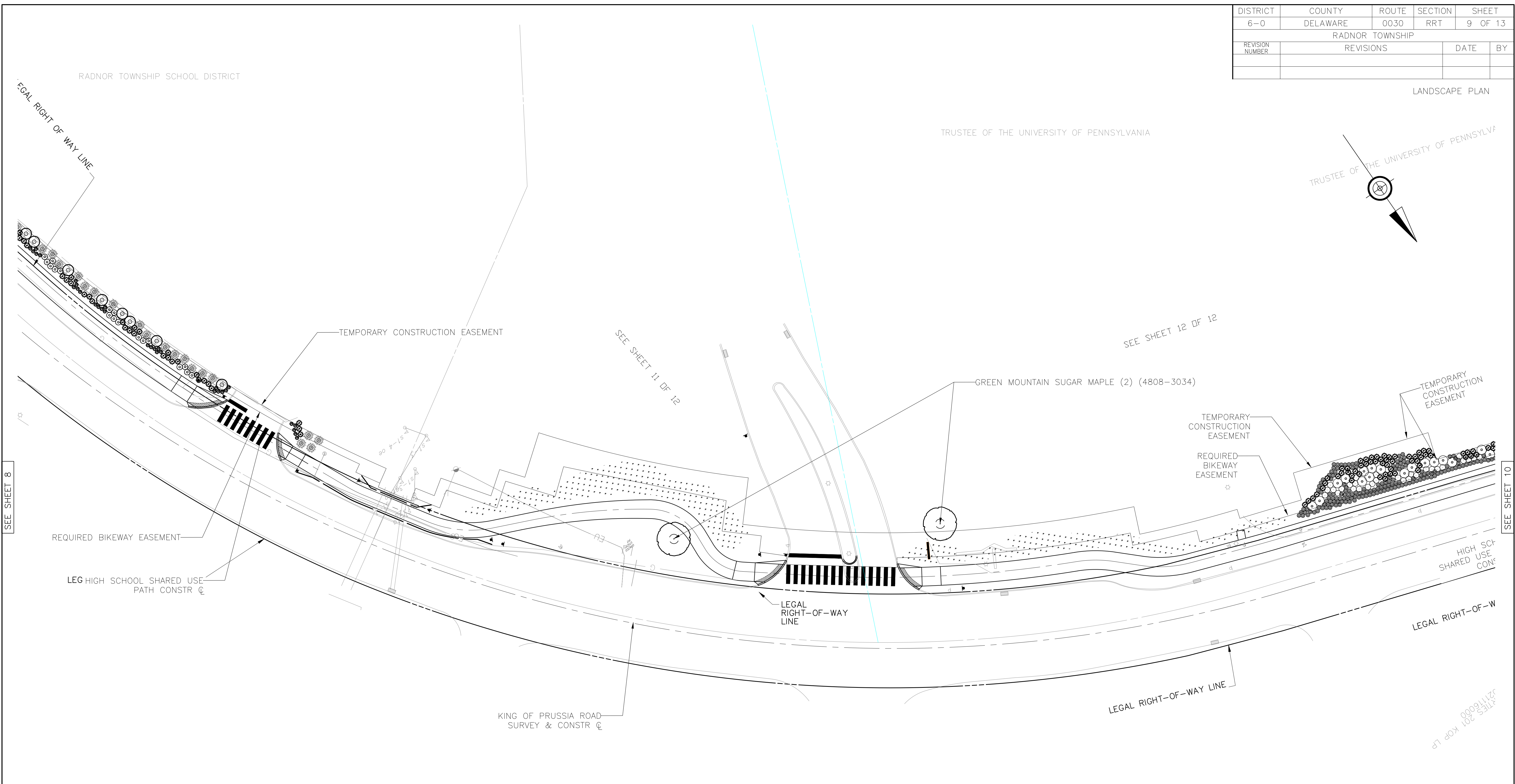
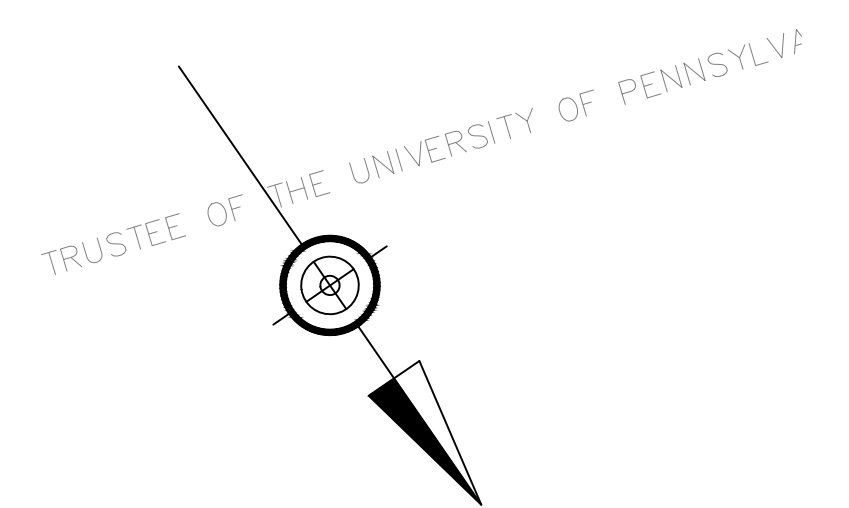

SEE SHEET 8

SEE SHEET 10

PLANT SCHEDULE:

ITEM NUMBER	ITEM NAME	QTY	
4808-3034	GREEN MOUNTAIN SUGAR MAPLE - (2 1/2" CAL. B&B) MODIFIED	2	EA

NOTES:
1. SEE THE EROSION AND SEDIMENTATION POLLUTION CONTROL PLAN SET FOR SEEDING TYPES.

LEGEND	
	PROPOSED ORNAMENTAL TREE
	PROPOSED SHADE TREE
	BASINS
	SLOPES 4:1 OR GREATER
	FINAL CONDITION LAWNS

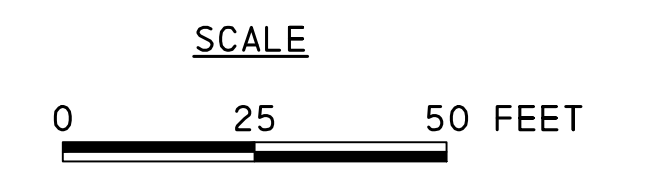

DATE: 02/16/2020
PROJECT: 201 KOP LP

DISTRICT	COUNTY	ROUTE	SECTION	SHEET
6-0	DELAWARE	0030	RRT	10 OF 13
RADNOR TOWNSHIP				
REVISION NUMBER	REVISIONS		DATE	BY

LANDSCAPE PLAN

TRUSTEE OF THE UNIVERSITY OF PENNSYLVANIA

SEE SHEET 12 OF 12

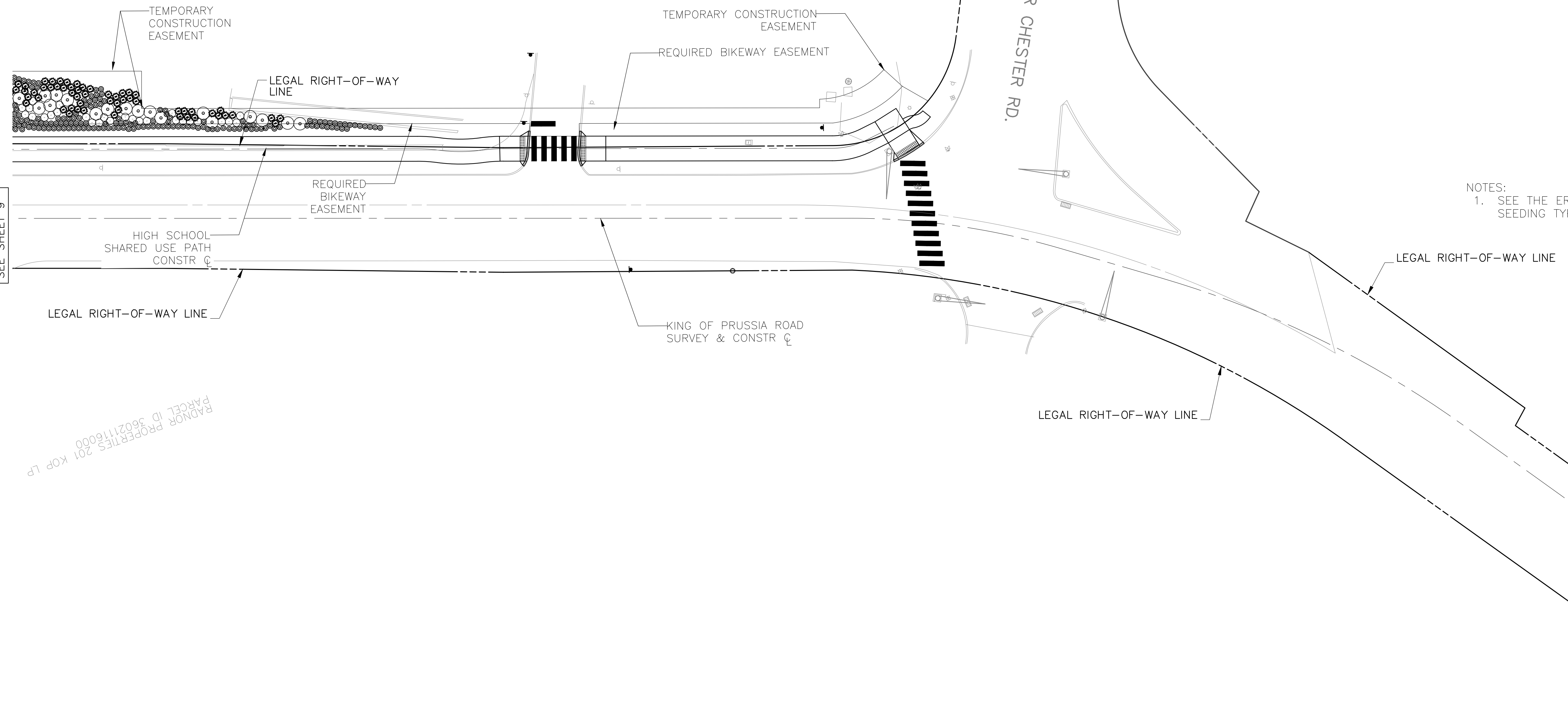
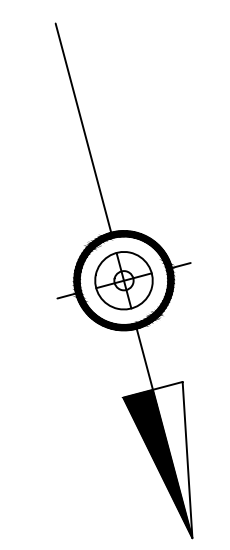

NOTES:
1. SEE THE EROSION AND SEDIMENTATION POLLUTION CONTROL PLAN SET FOR SEEDING TYPES.

LEGEND	
	PROPOSED ORNAMENTAL TREE
	PROPOSED SHADE TREE
	BASINS
	SLOPES 4:1 OR GREATER
	FINAL CONDITION LAWNS

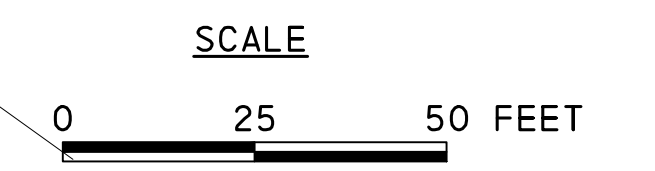

SEE SHEET 9

RADNOR PROPERTIES 201 KOP LP
PARCEL ID 36021116000



DISTRICT	COUNTY	ROUTE	SECTION	SHEET
6-0	DELAWARE	0030	RRT	11 OF 13
RADNOR TOWNSHIP				
REVISION NUMBER	REVISIONS		DATE	BY

LANDSCAPE PLAN

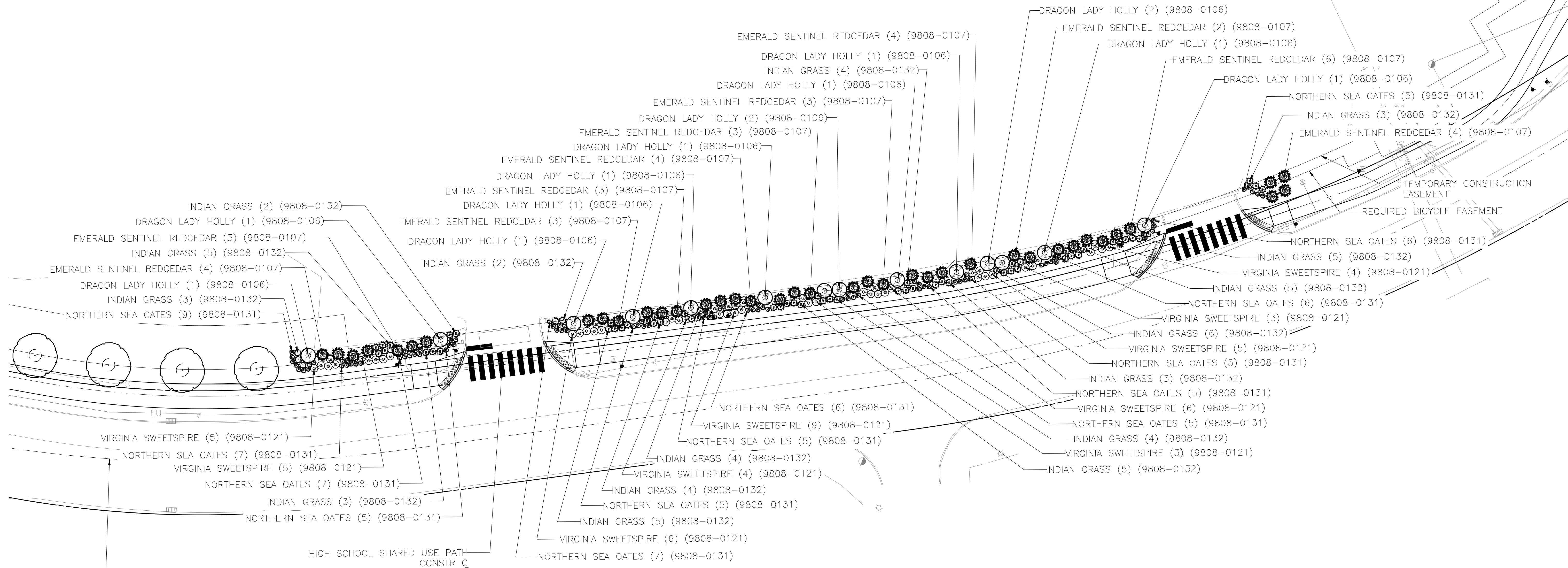
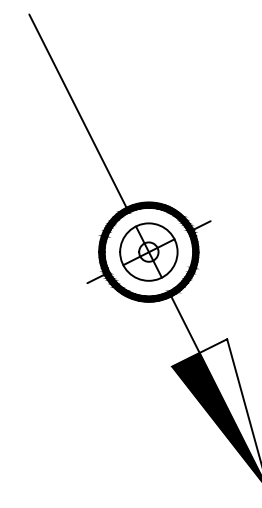

TEMPORARY CONSTRUCTION EASEMENT
REQUIRED BICYCLE EASEMENT

HIGH SCHOOL SHARED USE PATH
CONSTR C

KING OF PRUSSIA ROAD
SURVEY AND CONSTR C



PLANT SCHEDULE:

ITEM NUMBER	ITEM NAME	QTY	
9808-0106	DRAGON LADY HOLLY - (6' HT. B&B)	14	EA
9808-0107	EMERALD SENTINEL RED CEDAR - (6' HT. B&B)	39	EA
9808-0121	VIRGINIA SWEETSPIRE (24" HT. B&B OR CONTAINER)	50	EA
9808-0131	NORTHERN SEA OATES (3 GALLON CONTAINER)	83	EA
9808-0132	INDIAN GRASS (3 GALLON CONTAINER)	63	EA

LEGEND

- ⊙ PROPOSED DECIDUOUS SHRUB
- ⊙⊙ PROPOSED EVERGREEN TREE
- ⊙⊙ PROPOSED ORNAMENTAL GRASS
- ⊙ PROPOSED SHADE TREE

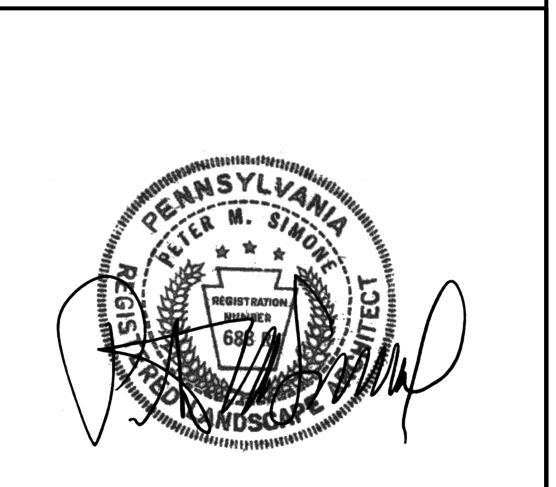

DISTRICT	COUNTY	ROUTE	SECTION	SHEET
6-0	DELAWARE	0030	RRT	12 OF 13
RADNOR TOWNSHIP				
REVISION NUMBER	REVISIONS			DATE BY

LANDSCAPE PLAN

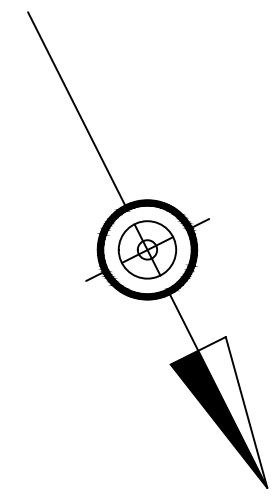

PLANT SCHEDULE:

ITEM NUMBER	ITEM NAME	QTY	EA
4808-4350	FRAGRANT SUMAC - (18" HT. B&B OR CONTAINER) MODIFIED	193	EA
9808-0122	GREY OWL JUNIPER (24" HT. B&B OR CONTAINER)	21	EA
9808-0133	BABY RUSSIAN SAGE 'BLUE JEAN BABY' (1 GALLON CONTAINER)	32	EA
9808-0132	INDIAN GRASS (3 GALLON CONTAINER)	64	EA

LEGEND

- PROPOSED DECIDUOUS SHRUB
- PROPOSED EVERGREEN SHRUB
- PROPOSED ORNAMENTAL GRASS
- PROPOSED PERENNIAL

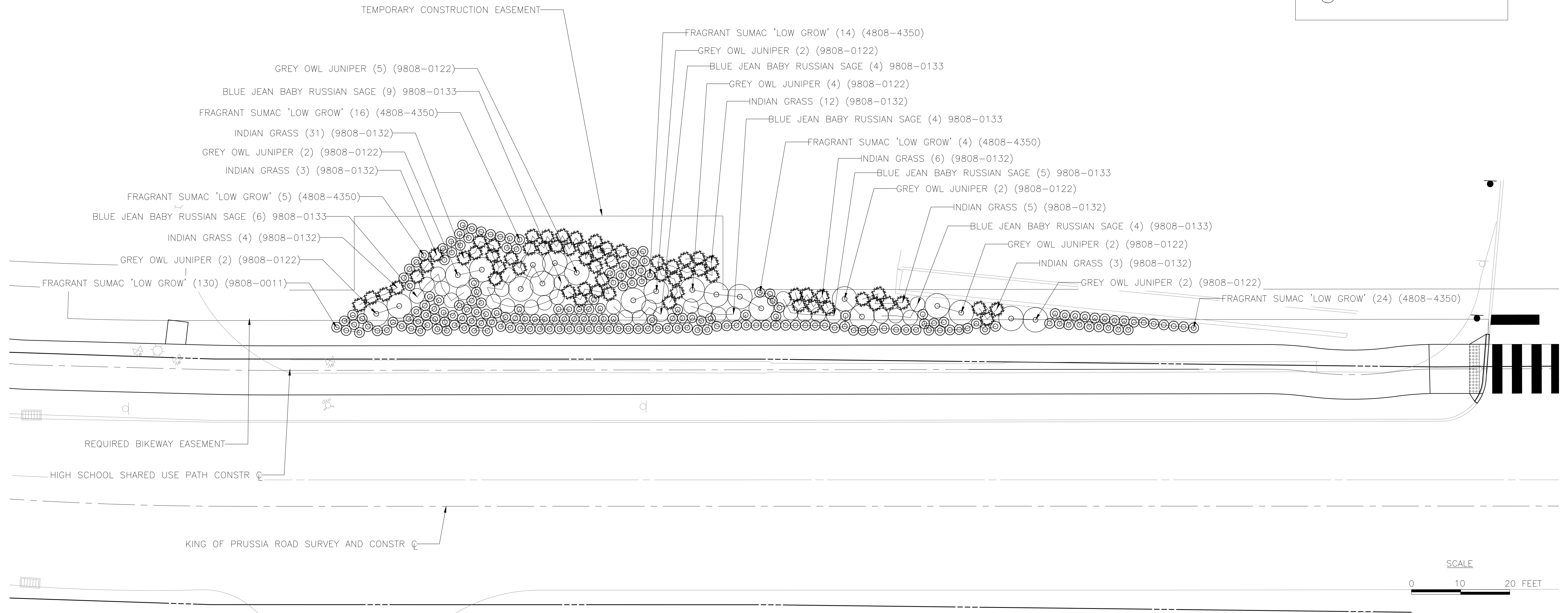

DISTRICT	COUNTY	ROUTE	SECTION	SHEET
6-0	DELAWARE	0030	RRT	12 OF 13
RADNOR TOWNSHIP				
REVISION NUMBER	REVISIONS	DATE	BY	

LANDSCAPE PLAN

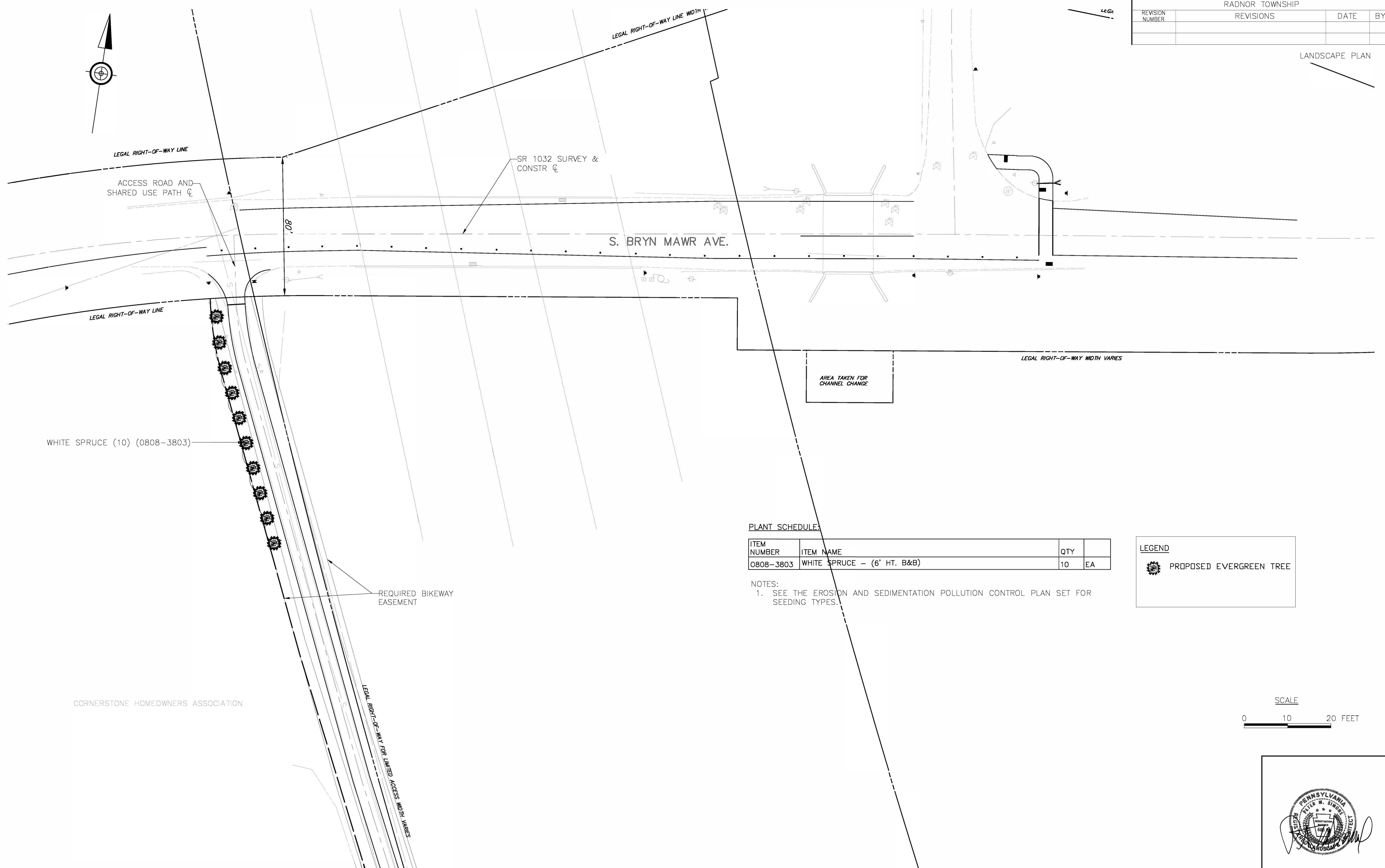
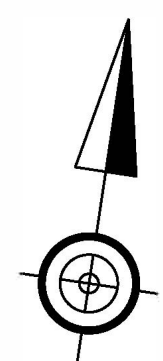

WHITE SPRUCE (10) (0808-3803)

PLANT SCHEDULE:

ITEM NUMBER	ITEM NAME	QTY	
0808-3803	WHITE SPRUCE - (6' HT. B&B)	10	EA

LEGEND

PROPOSED EVERGREEN TREE

NOTES:
 1. SEE THE EROSION AND SEDIMENTATION POLLUTION CONTROL PLAN SET FOR SEEDING TYPES.

CORNERSTONE HOMEOWNERS ASSOCIATION

